



Lower Thames Crossing

2.8 Streets Subject to Temporary Restrictions of Use Plans

Volume B (sheets 1 to 20)

(Tracked changes version)

APFP Regulations 5(2)(k) & 5(2)(o)

Infrastructure Planning (Applications:
Prescribed Forms and Procedure)
Regulations 2009

Volume 2

DATE: November, 2023
DEADLINE: 7,

Deleted: September

Deleted: 4

Planning Inspectorate Scheme Ref: TR010032
Application Document Ref: TR010032/APP/2.8

VERSION: 4.0

Deleted: 3

Revision history

Version	Date	Submitted at
1.0	31 October 2022	DCO Application
2.0	18 July 2023	Deadline 1
3.0	19 September 2023	Deadline 4
4.0	17 November 2023	Deadline 7

Lower Thames Crossing

2.8 Streets Subject to Temporary Restrictions of Use Plans

Volume B (sheets 1 to 20) (Tracked changes version)

List of contents

	Page number
1 Introduction	1
2 Schedule of Plans included in this application document	4

1 Introduction

- 1.1.1 This document is submitted to the Planning Inspectorate on behalf of the Secretary of State in relation to an application made by National Highways (the Applicant) under section 37 of the Planning Act 2008.
- 1.1.2 The application is for the grant of development consent for the A122 Lower Thames Crossing. Should development consent be granted, the draft A122 (Lower Thames Crossing) Development Consent Order (Application Document 3.1) (the draft Order) will be made by the Secretary of State (subject to any modifications considered appropriate).
- 1.1.3 This document comprises part of the suite of application documentation and is included in the application to comply with Regulations 5(2)(k) and 5(2)(o) of the Infrastructure Planning (Applications: Prescribed Forms and Procedure) Regulations 2009 which require:
- a. *5(2)(k) 'where applicable, a plan identifying any new or altered means of access, stopping up of streets or roads or any diversions, extinguishments or creation of rights of way or public rights of navigation.'*
 - b. *5(2)(o) any other plans, drawings and sections necessary to describe the proposals for which development consent is sought, showing details of design, external appearance, and the preferred layout of buildings or structures, drainage, surface water management, means of vehicular and pedestrian access, any car parking to be provided, and means of landscaping.*
 - c. *5(4) Where a plan comprises three or more separate sheets a key plan must be provided showing the relationship between the different sheets.'*
- 1.1.4 The purpose of the Streets Subject to Temporary Restrictions of Use Plans is to show the extents of streets or private means of access subject to temporary closure, alteration, diversion or restriction of use during construction of the authorised development.
- 1.1.5 The Applicant has adopted the same approach for the Streets Subject to Temporary Restrictions of Use Plans as has been used for the following:
- a. Land Plans (Application Document 2.2),
 - b. Crown Land Plans (Application Document 2.3),
 - c. Special Category Land Plans (Application Document 2.4)
 - d. General Arrangement Plans (Application Document 2.5)
 - e. Works Plans (Application Document 2.6)
 - f. Rights of Way and Access Plans (Application Document 2.7)
 - g. Traffic Regulation Measures Plans (Application document 2.10)

- h. Drainage Plans (Application Document 2.16)
 - i. Temporary Works Plans (Application Document 2.17)
 - j. Hedgerows and Tree Preservation Order Plans
(Application Document 2.18)
- 1.1.6 The information contained on each sheet of the Streets Subject to Temporary Restrictions of Use Plans corresponds with the information shown on each sheet of the aforementioned sets. This is intended to help interested parties understand the inter-relationship between the different sets of plans and to help illustrate the design of the Project more clearly.
- 1.1.7 This approach means that there are some sheets that cover an area of the Project where there is no Streets Subject to Temporary Restrictions of Use Plans design information to show. On these sheets, the Applicant has introduced a label stating: '*No design information on this sheet*'.
- 1.1.8 The Streets Subject to Temporary Restrictions of Use Plans show the Order Limits and the relevant local authority boundaries. In this plan set, 'the Order Limits' mean the limits of lands to be acquired or used, permanently or temporarily, within which the authorised development may be carried out (see article 2 of the draft Order (Application Document 3.1)).
- 1.1.9 This plan set uses a consistent key applicable to the plan set as a whole, rather than being tailored to each individual sheet. This means that there may be some items shown in the key that are not on a given sheet.
- 1.1.10 This plan set uses a dashed black line to show existing streets or private means of access subject to temporary closure, alteration, diversion or restriction of use during construction of the authorised development. The term 'street' used here includes vehicular highways with any associated footway, cycle track (footway/cycleway) or verge; other highways (footpaths, bridleways and byways); and other streets, including permissive paths. Start and end points on the plans are listed in Schedule 3 of the draft Order (Application Document 3.1) and used to describe extents of streets. Streets and reference points are listed in the same order as the drawing sheets of the Streets Subject to Temporary Restrictions of Use Plans to help interested parties find information about a particular street(s). On dual carriageways, the black dashed line does not cover the entire width of the street; this has been done so as not to hide other information on the plans. On all streets, the black dashed line represents the full extent (width) of the street, including any footway, cycle track (footway/cycleway) or verge.
- 1.1.11 As this document is informed by and part of the application documentation, it should be read alongside the other application documents. In particular, the plans should be read alongside Schedule 3 of the draft Order (Application Document 3.1).
- 1.1.12 To ensure that the file size of this document does not exceed the 50MB limit prescribed by the Planning Inspectorate, the set has been split into three volumes: volume A contains the key plan, volume B the initial sheets 1 to 20 and volume C contains the following sheets, 21 to 49.

- 1.1.13 These plans have been updated at Deadline 1 to address minor drafting inaccuracies.
- 1.1.14 These plans have been updated for Deadline 4 to include the proposed changes MRC01, MRC02 and MRC03 following the procedural decision made by the Examining Authority [\[PD-031\]](#).
- 1.1.15 These plans have been updated for Deadline 7 to include the proposed amendment EA07, as detailed in Deadline 5 cover letter [\[REP5-001\]](#).

2 Schedule of Plans included in this application document

Document Title	Document Number	Revision
STREETS SUBJECT TO TEMPORARY RESTRICTIONS OF USE REGULATION 5(2)(k) & 5(2)(o) KEY PLAN	TR010032/APP/2.8	P04
STREETS SUBJECT TO TEMPORARY RESTRICTIONS OF USE REGULATION 5(2)(k) & 5(2)(o) SHEET 1	TR010032/APP/2.8	P02
STREETS SUBJECT TO TEMPORARY RESTRICTIONS OF USE REGULATION 5(2)(k) & 5(2)(o) SHEET 2	TR010032/APP/2.8	P02
STREETS SUBJECT TO TEMPORARY RESTRICTIONS OF USE REGULATION 5(2)(k) & 5(2)(o) SHEET 3	TR010032/APP/2.8	P01
STREETS SUBJECT TO TEMPORARY RESTRICTIONS OF USE REGULATION 5(2)(k) & 5(2)(o) SHEET 4	TR010032/APP/2.8	P01
STREETS SUBJECT TO TEMPORARY RESTRICTIONS OF USE REGULATION 5(2)(k) & 5(2)(o) SHEET 5	TR010032/APP/2.8	P01
STREETS SUBJECT TO TEMPORARY RESTRICTIONS OF USE REGULATION 5(2)(k) & 5(2)(o) SHEET 6	TR010032/APP/2.8	P02
STREETS SUBJECT TO TEMPORARY RESTRICTIONS OF USE REGULATION 5(2)(k) & 5(2)(o) SHEET 7	TR010032/APP/2.8	P01
STREETS SUBJECT TO TEMPORARY RESTRICTIONS OF USE REGULATION 5(2)(k) & 5(2)(o) SHEET 8	TR010032/APP/2.8	P01
STREETS SUBJECT TO TEMPORARY RESTRICTIONS OF USE REGULATION 5(2)(k) & 5(2)(o) SHEET 9	TR010032/APP/2.8	P01

Deleted: P03

Document Title	Document Number	Revision
STREETS SUBJECT TO TEMPORARY RESTRICTIONS OF USE REGULATION 5(2)(k) & 5(2)(o) SHEET 10	TR010032/APP/2.8	P01
STREETS SUBJECT TO TEMPORARY RESTRICTIONS OF USE REGULATION 5(2)(k) & 5(2)(o) SHEET 11	TR010032/APP/2.8	P01
STREETS SUBJECT TO TEMPORARY RESTRICTIONS OF USE REGULATION 5(2)(k) & 5(2)(o) SHEET 12	TR010032/APP/2.8	P01
STREETS SUBJECT TO TEMPORARY RESTRICTIONS OF USE REGULATION 5(2)(k) & 5(2)(o) SHEET 13	TR010032/APP/2.8	P02
STREETS SUBJECT TO TEMPORARY RESTRICTIONS OF USE REGULATION 5(2)(k) & 5(2)(o) SHEET 14	TR010032/APP/2.8	P01
STREETS SUBJECT TO TEMPORARY RESTRICTIONS OF USE REGULATION 5(2)(k) & 5(2)(o) SHEET 15	TR010032/APP/2.8	P01
STREETS SUBJECT TO TEMPORARY RESTRICTIONS OF USE REGULATION 5(2)(k) & 5(2)(o) SHEET 16	TR010032/APP/2.8	P01
STREETS SUBJECT TO TEMPORARY RESTRICTIONS OF USE REGULATION 5(2)(k) & 5(2)(o) SHEET 17	TR010032/APP/2.8	P02
STREETS SUBJECT TO TEMPORARY RESTRICTIONS OF USE REGULATION 5(2)(k) & 5(2)(o) SHEET 18	TR010032/APP/2.8	P01
STREETS SUBJECT TO TEMPORARY RESTRICTIONS OF USE REGULATION 5(2)(k) & 5(2)(o) SHEET 19	TR010032/APP/2.8	P01
STREETS SUBJECT TO TEMPORARY RESTRICTIONS OF USE REGULATION 5(2)(k) & 5(2)(o)	TR010032/APP/2.8	P01

Deleted: P01

Document Title	Document Number	Revision
SHEET 20		
STREETS SUBJECT TO TEMPORARY RESTRICTIONS OF USE REGULATION 5(2)(k) & 5(2)(o) SHEET 21	TR010032/APP/2.8	P02
STREETS SUBJECT TO TEMPORARY RESTRICTIONS OF USE REGULATION 5(2)(k) & 5(2)(o) SHEET 22	TR010032/APP/2.8	P02
STREETS SUBJECT TO TEMPORARY RESTRICTIONS OF USE REGULATION 5(2)(k) & 5(2)(o) SHEET 23	TR010032/APP/2.8	P03
STREETS SUBJECT TO TEMPORARY RESTRICTIONS OF USE REGULATION 5(2)(k) & 5(2)(o) SHEET 24	TR010032/APP/2.8	P02
STREETS SUBJECT TO TEMPORARY RESTRICTIONS OF USE REGULATION 5(2)(k) & 5(2)(o) SHEET 25	TR010032/APP/2.8	P01
STREETS SUBJECT TO TEMPORARY RESTRICTIONS OF USE REGULATION 5(2)(k) & 5(2)(o) SHEET 26	TR010032/APP/2.8	P01
STREETS SUBJECT TO TEMPORARY RESTRICTIONS OF USE REGULATION 5(2)(k) & 5(2)(o) SHEET 27	TR010032/APP/2.8	P01
STREETS SUBJECT TO TEMPORARY RESTRICTIONS OF USE REGULATION 5(2)(k) & 5(2)(o) SHEET 28	TR010032/APP/2.8	P01
STREETS SUBJECT TO TEMPORARY RESTRICTIONS OF USE REGULATION 5(2)(k) & 5(2)(o) SHEET 29	TR010032/APP/2.8	P01
STREETS SUBJECT TO TEMPORARY RESTRICTIONS OF USE REGULATION 5(2)(k) & 5(2)(o) SHEET 30	TR010032/APP/2.8	P01
STREETS SUBJECT TO TEMPORARY RESTRICTIONS OF USE	TR010032/APP/2.8	P01

Deleted: P01

Document Title	Document Number	Revision
REGULATION 5(2)(k) & 5(2)(o) SHEET 31		
STREETS SUBJECT TO TEMPORARY RESTRICTIONS OF USE REGULATION 5(2)(k) & 5(2)(o) SHEET 32	TR010032/APP/2.8	P02
STREETS SUBJECT TO TEMPORARY RESTRICTIONS OF USE REGULATION 5(2)(k) & 5(2)(o) SHEET 33	TR010032/APP/2.8	P01
STREETS SUBJECT TO TEMPORARY RESTRICTIONS OF USE REGULATION 5(2)(k) & 5(2)(o) SHEET 34	TR010032/APP/2.8	P01
STREETS SUBJECT TO TEMPORARY RESTRICTIONS OF USE REGULATION 5(2)(k) & 5(2)(o) SHEET 35	TR010032/APP/2.8	P01
STREETS SUBJECT TO TEMPORARY RESTRICTIONS OF USE REGULATION 5(2)(k) & 5(2)(o) SHEET 36	TR010032/APP/2.8	P01
STREETS SUBJECT TO TEMPORARY RESTRICTIONS OF USE REGULATION 5(2)(k) & 5(2)(o) SHEET 37	TR010032/APP/2.8	P01
STREETS SUBJECT TO TEMPORARY RESTRICTIONS OF USE REGULATION 5(2)(k) & 5(2)(o) SHEET 38	TR010032/APP/2.8	P01
STREETS SUBJECT TO TEMPORARY RESTRICTIONS OF USE REGULATION 5(2)(k) & 5(2)(o) SHEET 39	TR010032/APP/2.8	P01
STREETS SUBJECT TO TEMPORARY RESTRICTIONS OF USE REGULATION 5(2)(k) & 5(2)(o) SHEET 40	TR010032/APP/2.8	P02
STREETS SUBJECT TO TEMPORARY RESTRICTIONS OF USE REGULATION 5(2)(k) & 5(2)(o) SHEET 41	TR010032/APP/2.8	P01

Document Title	Document Number	Revision
STREETS SUBJECT TO TEMPORARY RESTRICTIONS OF USE REGULATION 5(2)(k) & 5(2)(o) SHEET 42	TR010032/APP/2.8	P02
STREETS SUBJECT TO TEMPORARY RESTRICTIONS OF USE REGULATION 5(2)(k) & 5(2)(o) SHEET 43	TR010032/APP/2.8	P01
STREETS SUBJECT TO TEMPORARY RESTRICTIONS OF USE REGULATION 5(2)(k) & 5(2)(o) SHEET 44	TR010032/APP/2.8	P02
STREETS SUBJECT TO TEMPORARY RESTRICTIONS OF USE REGULATION 5(2)(k) & 5(2)(o) SHEET 45	TR010032/APP/2.8	P02
STREETS SUBJECT TO TEMPORARY RESTRICTIONS OF USE REGULATION 5(2)(k) & 5(2)(o) SHEET 46	TR010032/APP/2.8	P01
STREETS SUBJECT TO TEMPORARY RESTRICTIONS OF USE REGULATION 5(2)(k) & 5(2)(o) SHEET 47	TR010032/APP/2.8	P01
STREETS SUBJECT TO TEMPORARY RESTRICTIONS OF USE REGULATION 5(2)(k) & 5(2)(o) SHEET 48	TR010032/APP/2.8	P01
STREETS SUBJECT TO TEMPORARY RESTRICTIONS OF USE REGULATION 5(2)(k) & 5(2)(o) SHEET 49	TR010032/APP/2.8	P01

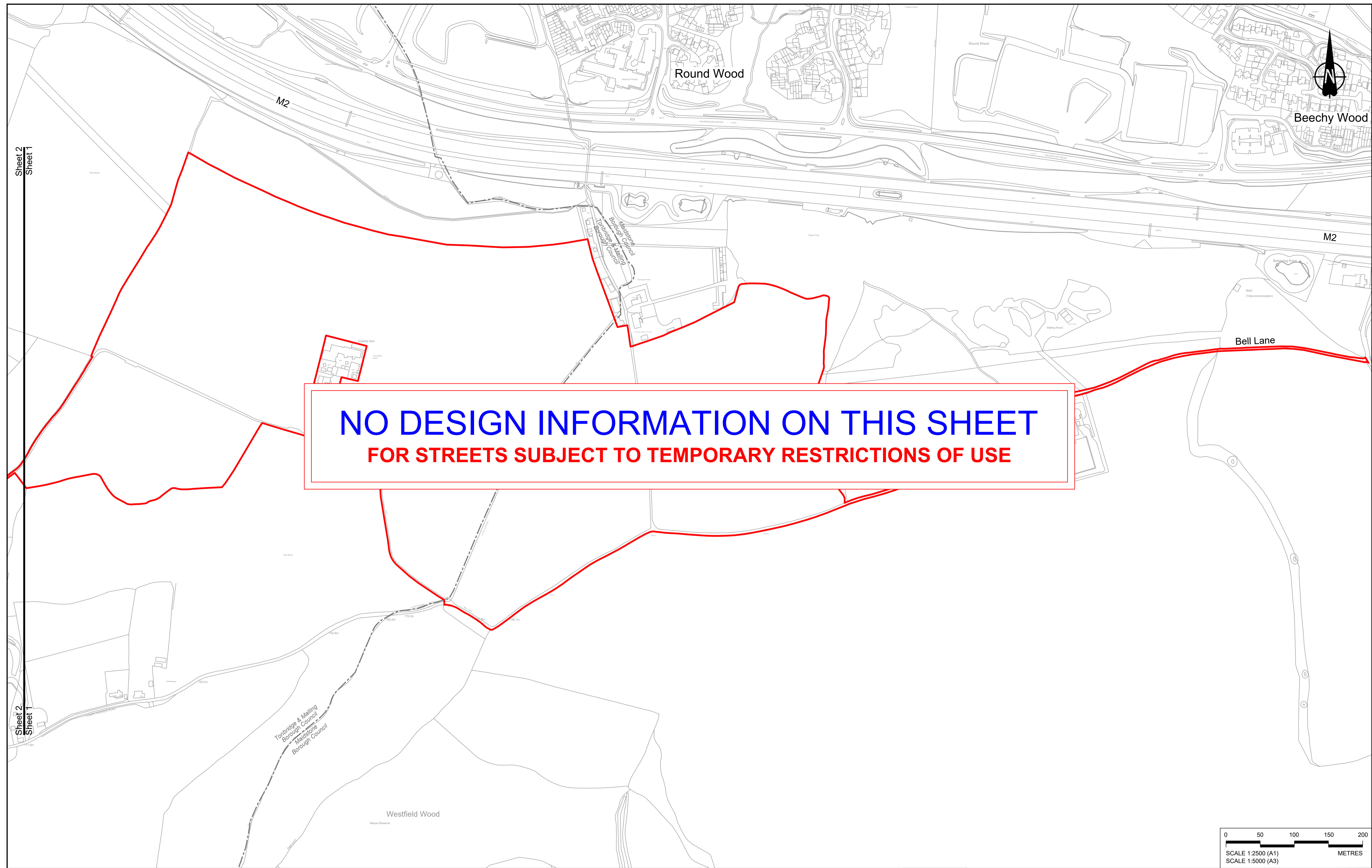

**NO DESIGN INFORMATION ON THIS SHEET
FOR STREETS SUBJECT TO TEMPORARY RESTRICTIONS OF USE**

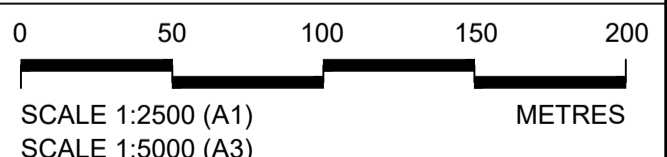

Rev	Status	Rev. Date	Purpose of revision	Drawn	Chck'd	Apprv'd
P01	S8	19/10/2022	DCO Application	GP	BB	ASB
P02	S8	19/09/2023	Deadline 4	GP	RO	ASB

NOTES:

- The proposed temporary restrictions of use shown here will be subject to change as part of detailed design development. Any changes will be limited to being within the constraints included in the Development Consent Order (application document reference TR010032/APP/3.1).
- These plans should be read in conjunction with Schedule 3 of the Development Consent Order (application document reference TR010032/APP/3.1).

LEGEND:

- Order Limits
- Local Authority Boundary
- Streets subject to temporary alteration, diversion and restriction of use

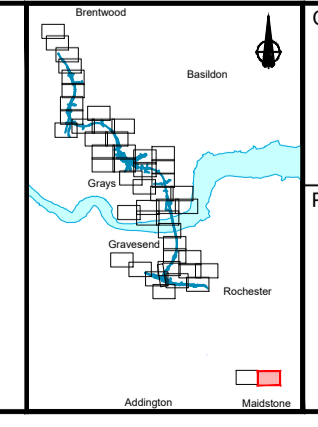

Client: **national highways**

Project: **LOWER THAMES CROSSING**

Status	DCO Examination	Original Size	A1	Revision	P02
Application Document Number	TR010032/APP/2.8	Scale	1:2500		
Drawing title	STREETS SUBJECT TO TEMPORARY RESTRICTIONS OF USE, REGULATION 5(2)(k) & 5(2)(o), SHEET 1				
Drawing Number	HE540039-CJV-BOP-SZZ_GN000000_-DR-CX-40048				

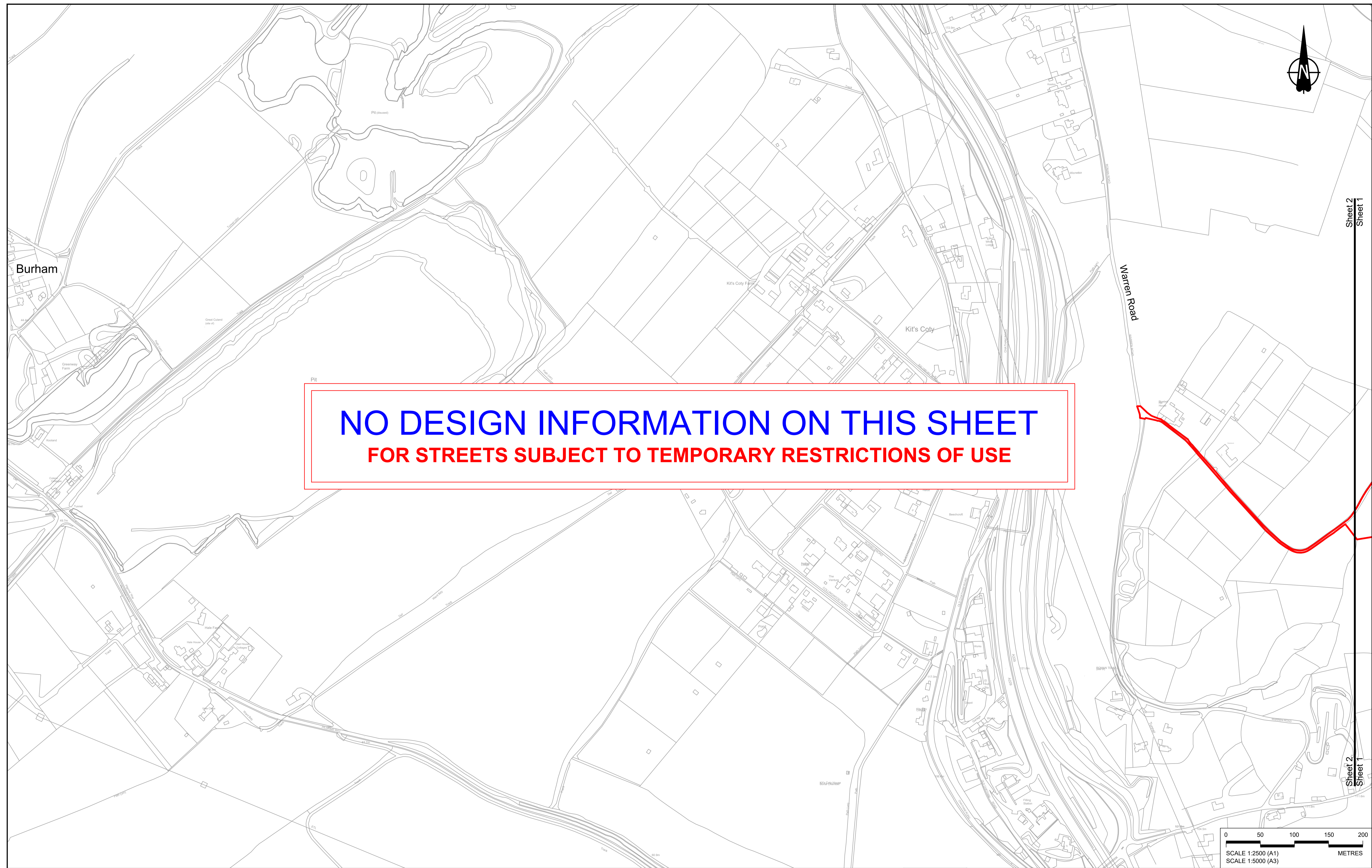

**NO DESIGN INFORMATION ON THIS SHEET
FOR STREETS SUBJECT TO TEMPORARY RESTRICTIONS OF USE**

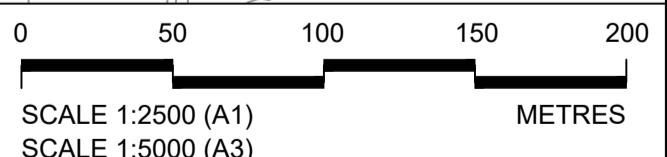

Contains Ordnance Survey data. © Crown copyright and database rights 2022. Ordnance Survey 100030649

Rev	Status	Rev. Date	Purpose of revision	Drawn	Chkd	Apprv'd
P01	S8	19/10/2022	DCO Application	GP	BB	ASB
P02	S8	19/09/2023	Deadline 4	GP	RO	ASB

NOTES:

- The proposed temporary restrictions of use shown here will be subject to change as part of detailed design development. Any changes will be limited to being within the constraints included in the Development Consent Order (application document reference TR010032/APP/3.1).
- These plans should be read in conjunction with Schedule 3 of the Development Consent Order (application document reference TR010032/APP/3.1).

LEGEND:

- Order Limits
- — — Local Authority Boundary
- ■ ■ ■ Streets subject to temporary alteration, diversion and restriction of use

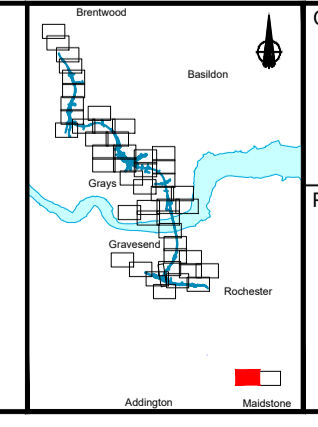

Client: **national highways**

Project: **LOWER THAMES CROSSING**

Status	DCO Examination	Original Size	A1	Revision	P02
Application Document Number	TR010032/APP/2.8	Scale	1:2500		
Drawing title	STREETS SUBJECT TO TEMPORARY RESTRICTIONS OF USE, REGULATION 5(2)(k) & 5(2)(o), SHEET 2				
Drawing Number	HE540039-CJV-BOP-SZZ_GN000000_-DR-CX-40049				

Sheet 2
Sheet 1

Sheet 2
Sheet 1

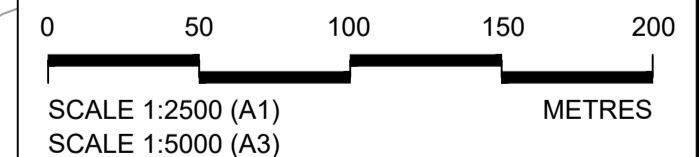
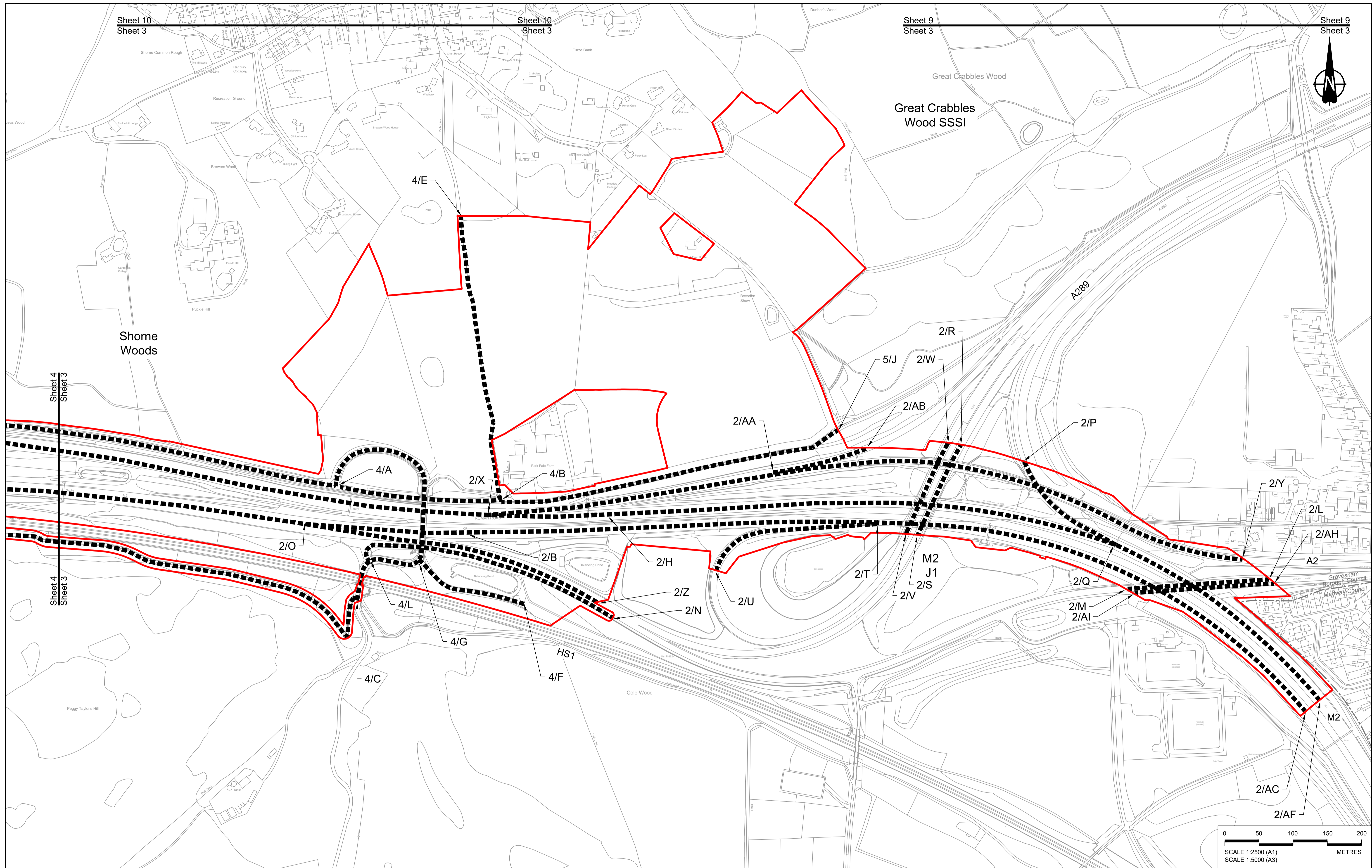

Contains Ordnance Survey data. © Crown copyright and database rights 2022. Ordnance Survey 100039649

P01	SB	19/10/2022	DCO Application	GP	BB	ASB
Rev	Status	Rev. Date	Purpose of revision	Drawn	Check'd	Apprv'd

NOTES:

- The proposed temporary restrictions of use shown here will be subject to change as part of detailed design development. Any changes will be limited to being within the constraints included in the Development Consent Order (application document reference TR010032/APP/3.1).
- These plans should be read in conjunction with Schedule 3 of the Development Consent Order (application document reference TR010032/APP/3.1).

LEGEND:

- Order Limits
- Local Authority Boundary
- ▬▬▬ Streets subject to temporary alteration, diversion and restriction of use

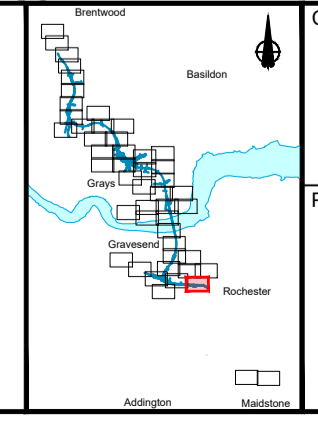

Client: **national highways**

Project: **LOWER THAMES CROSSING**

Status: **DCO Application**

Application Document Number: **TR010032/APP/2.8**

Drawing title: **STREETS SUBJECT TO TEMPORARY RESTRICTIONS OF USE, REGULATION 5(2)(k) & 5(2)(o), SHEET 3**

Drawing Number: **HE540039-CJV-BOP-SZZ_GN000000_-DR-CX-40001**

Original Size: **A1** | Revision: **P01**

Scale: **1:2500**

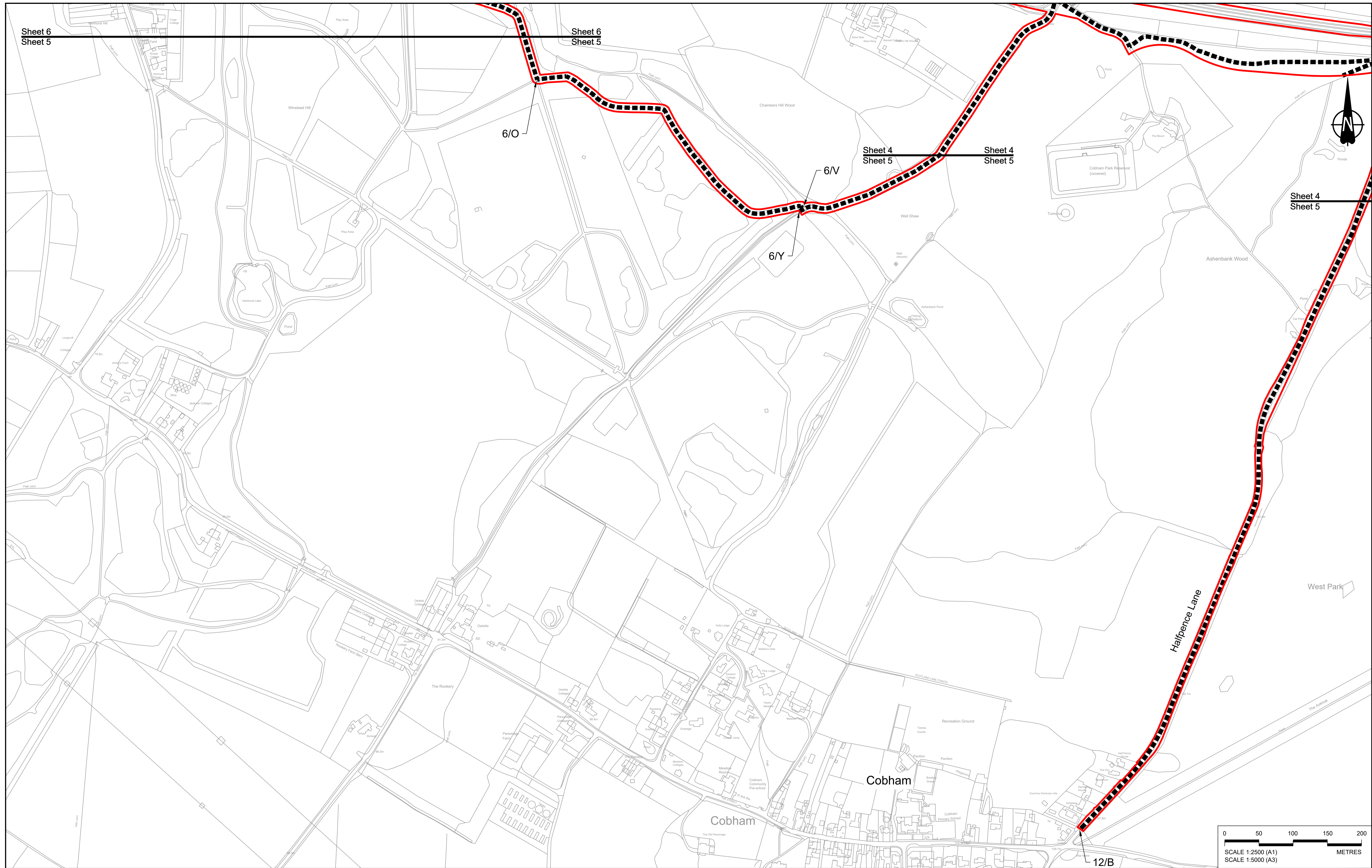

Contains Ordnance Survey data. © Crown copyright and database rights 2022. Ordnance Survey 100039649

P01	SB	19/10/2022	DCO Application	GP	BB	ASB
Rev	Status	Rev. Date	Purpose of revision	Drawn	Chck'd	Apprv'd

NOTES:

- The proposed temporary restrictions of use shown here will be subject to change as part of detailed design development. Any changes will be limited to being within the constraints included in the Development Consent Order (application document reference TR010032/APP/3.1).
- These plans should be read in conjunction with Schedule 3 of the Development Consent Order (application document reference TR010032/APP/3.1).

LEGEND:

- Order Limits
- — — Local Authority Boundary
- ■ ■ ■ Streets subject to temporary alteration, diversion and restriction of use

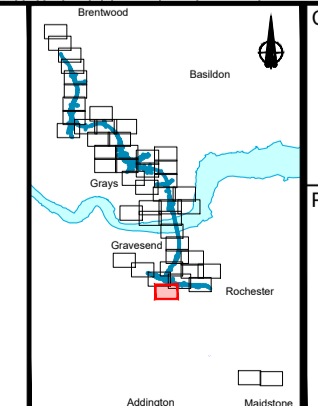

Client: **national highways**

Project: **LOWER THAMES CROSSING**

Status: DCO Application	Original Size: A1	Revision: P01
Application Document Number: TR010032/APP/2.8	Scale: 1:2500	
STREETS SUBJECT TO TEMPORARY RESTRICTIONS OF USE, REGULATION 5(2)(k) & 5(2)(o), SHEET 5		
Drawing Number: HE540039-CJV-BOP-SZZ_GN000000_-DR-CX-40003		

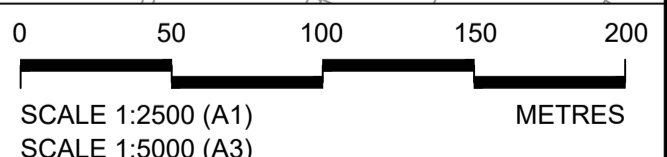
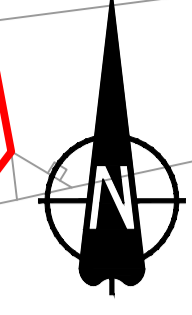
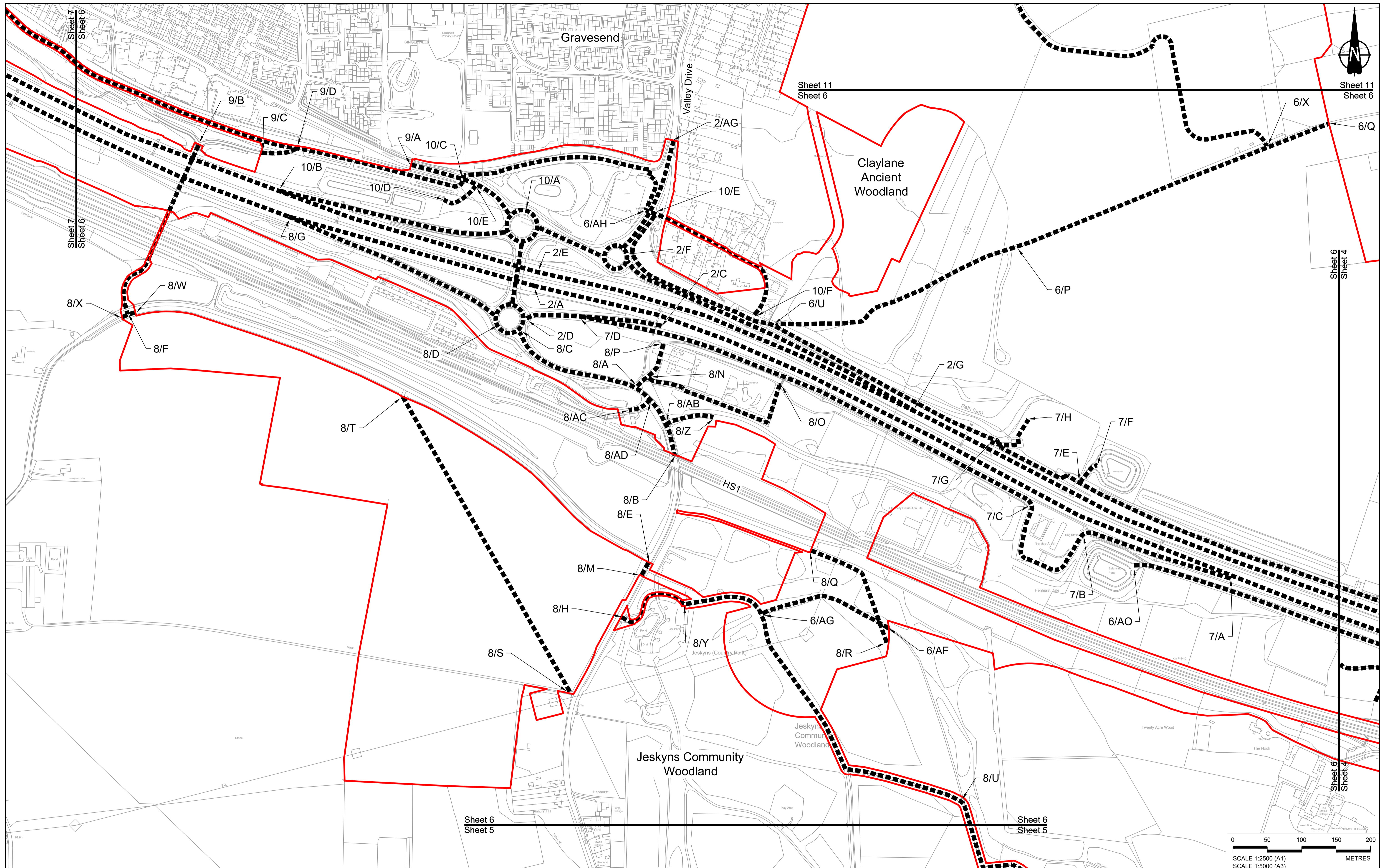

Contains Ordnance Survey data. © Crown copyright and database rights 2022. Ordnance Survey 100039649						
P01	S8	19/10/2022	DCO Application	GP	BB	ASB
P02	S8	19/07/2023	Deadline 1	GP	RO	ASB
Rev	Status	Rev. Date	Purpose of revision	Drawn	Chck'd	Apprv'd

NOTES:

- The proposed temporary restrictions of use shown here will be subject to change as part of detailed design development. Any changes will be limited to being within the constraints included in the Development Consent Order (application document reference TR010032/APP/3.1).
- These plans should be read in conjunction with Schedule 3 of the Development Consent Order (application document reference TR010032/APP/3.1).

LEGEND:

- Order Limits
- Local Authority Boundary
- Streets subject to temporary alteration, diversion and restriction of use

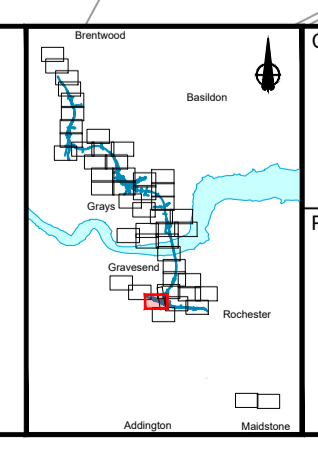

Client: **national highways**

Project: **LOWER THAMES CROSSING**

Status: DCO Application

Application Document Number: TR010032/APP/2.8

Drawing title: **STREETS SUBJECT TO TEMPORARY RESTRICTIONS OF USE, REGULATION 5(2)(k) & 5(2)(o), SHEET 6**

Drawing Number: HE540039-CJV-BOP-SZZ_GN000000_-DR-CX-40004

Original Size: A1
Revision: P02
Scale: 1:2500

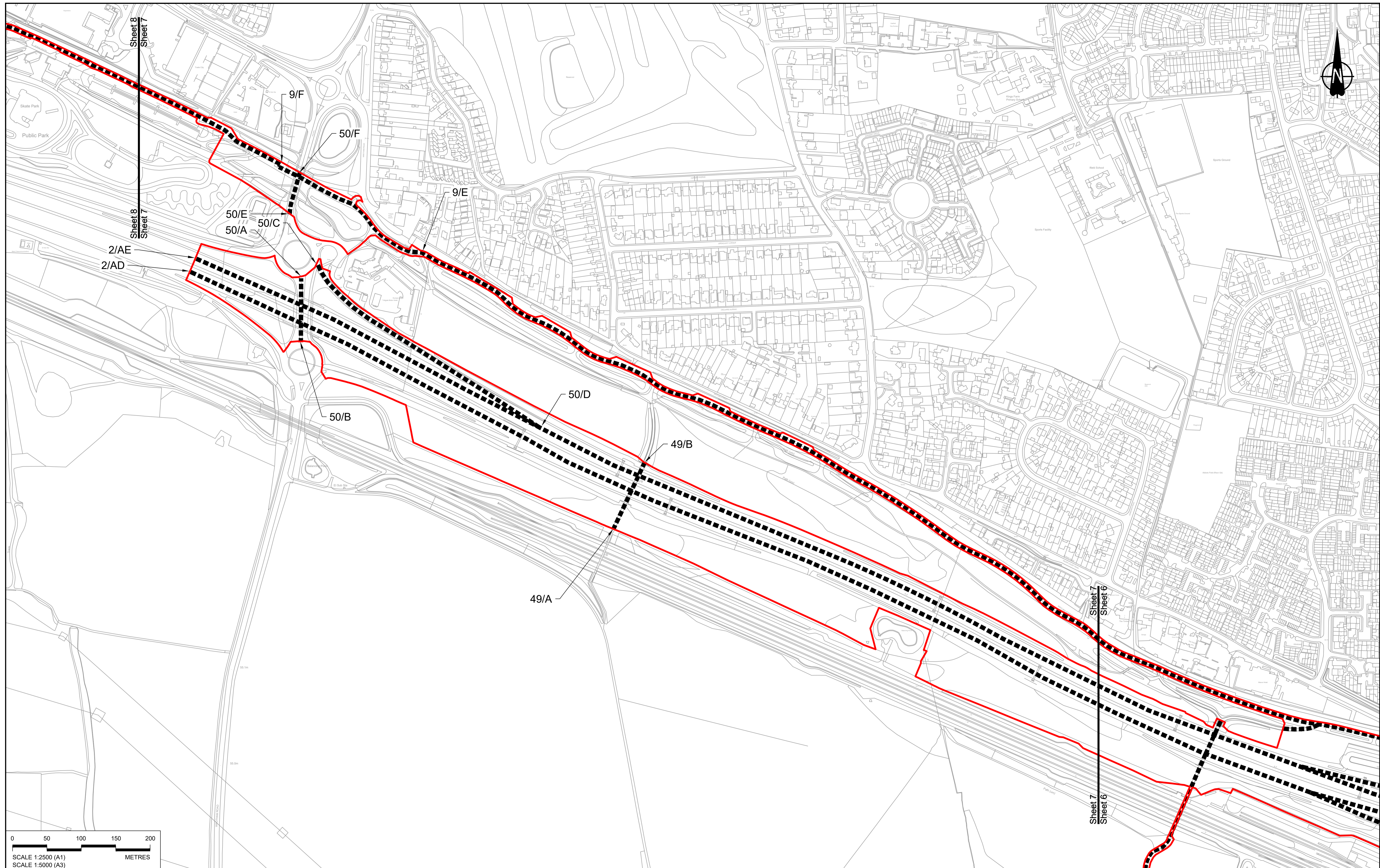

Contains Ordnance Survey data. © Crown copyright and database rights 2022. Ordnance Survey 100039649

P01	SB	19/10/2022	DCO Application	GP	BB	ASB
Rev	Status	Rev. Date	Purpose of revision	Drawn	Chck'd	Apprv'd

NOTES:

- The proposed temporary restrictions of use shown here will be subject to change as part of detailed design development. Any changes will be limited to being within the constraints included in the Development Consent Order (application document reference TR010032/APP/3.1).
- These plans should be read in conjunction with Schedule 3 of the Development Consent Order (application document reference TR010032/APP/3.1).

LEGEND:

- Order Limits
- Local Authority Boundary
- Streets subject to temporary alteration, diversion and restriction of use

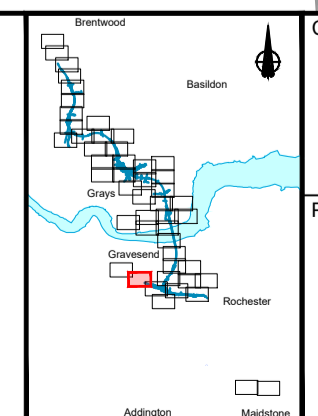

Client: **national highways**

Project: **LOWER THAMES CROSSING**

Status	DCO Application	Original Size	Revision
Application Document Number	TR010032/APP/2.8	A1	P01
Drawing title	STREETS SUBJECT TO TEMPORARY RESTRICTIONS OF USE, REGULATION 5(2)(k) & 5(2)(o), SHEET 7		
Drawing Number	HE540039-CJV-BOP-SZZ_GN000000_-DR-CX-40005		

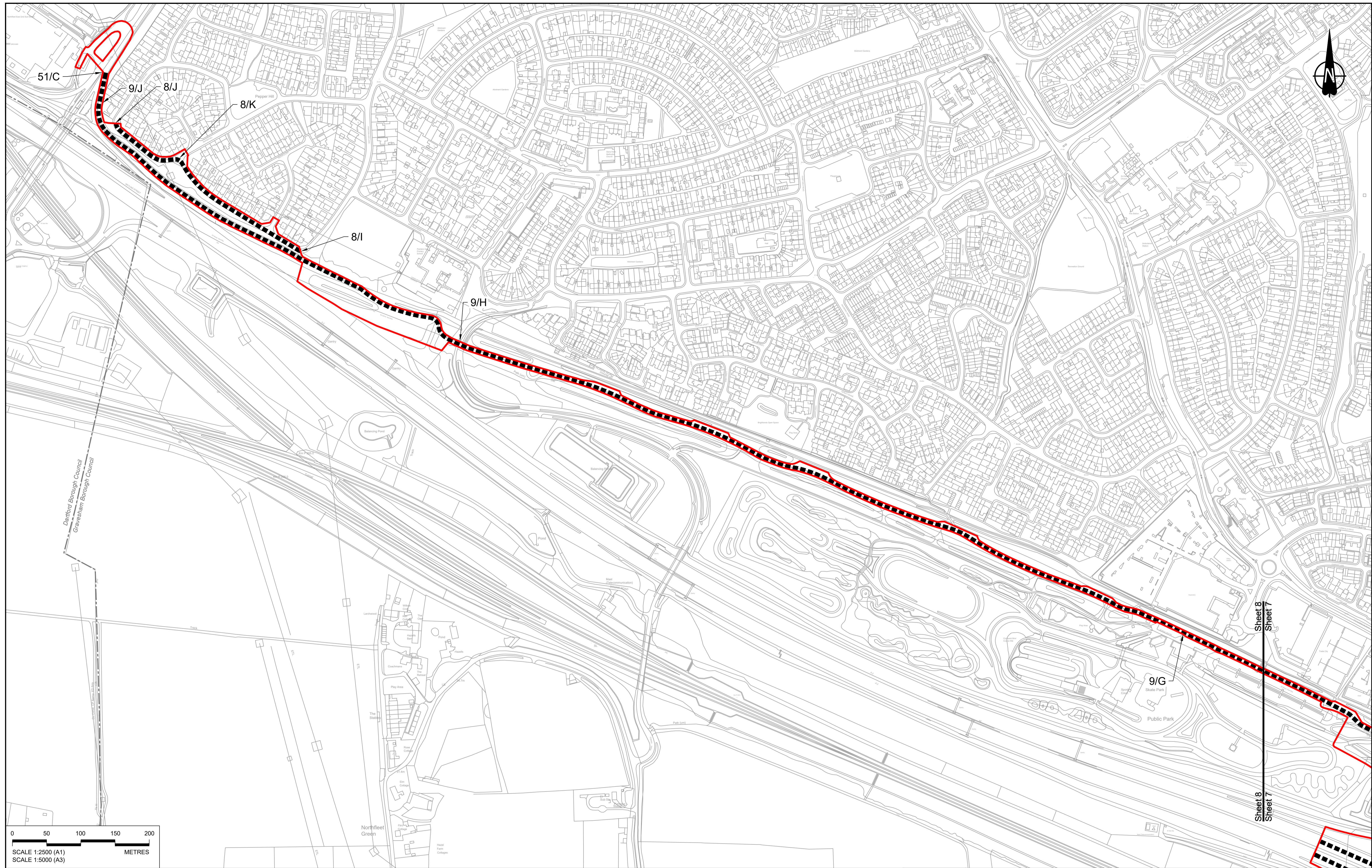

0 50 100 150 200 METRES

SCALE 1:2500 (A1)
SCALE 1:5000 (A3)

Rev	Status	Rev. Date	Purpose of revision	Drawn	Chck'd	Apprv'd
P01	SB	19/10/2022	DCO Application	GP	BB	ASB

NOTES:

- The proposed temporary restrictions of use shown here will be subject to change as part of detailed design development. Any changes will be limited to being within the constraints included in the Development Consent Order (application document reference TR010032/APP/3.1).
- These plans should be read in conjunction with Schedule 3 of the Development Consent Order (application document reference TR010032/APP/3.1).

LEGEND:

- Order Limits
- Local Authority Boundary
- Streets subject to temporary alteration, diversion and restriction of use

Contains Ordnance Survey data. © Crown copyright and database rights 2022. Ordnance Survey 100039649

Client: national highways

Project: LOWER THAMES CROSSING

Status	DCO Application	Original Size	Revision
Application Document Number	TR010032/APP/2.8	A1	P01
Drawing Title	STREETS SUBJECT TO TEMPORARY RESTRICTIONS OF USE, REGULATION 5(2)(k) & 5(2)(o), SHEET 8		
Drawing Number	HE540039-CJV-BOP-SZZ_GN000000_-DR-CX-40006		

Scale 1:2500

HE540039-CJV-BOP-SZZ_GN000000_-DR-CX-40006.dwg

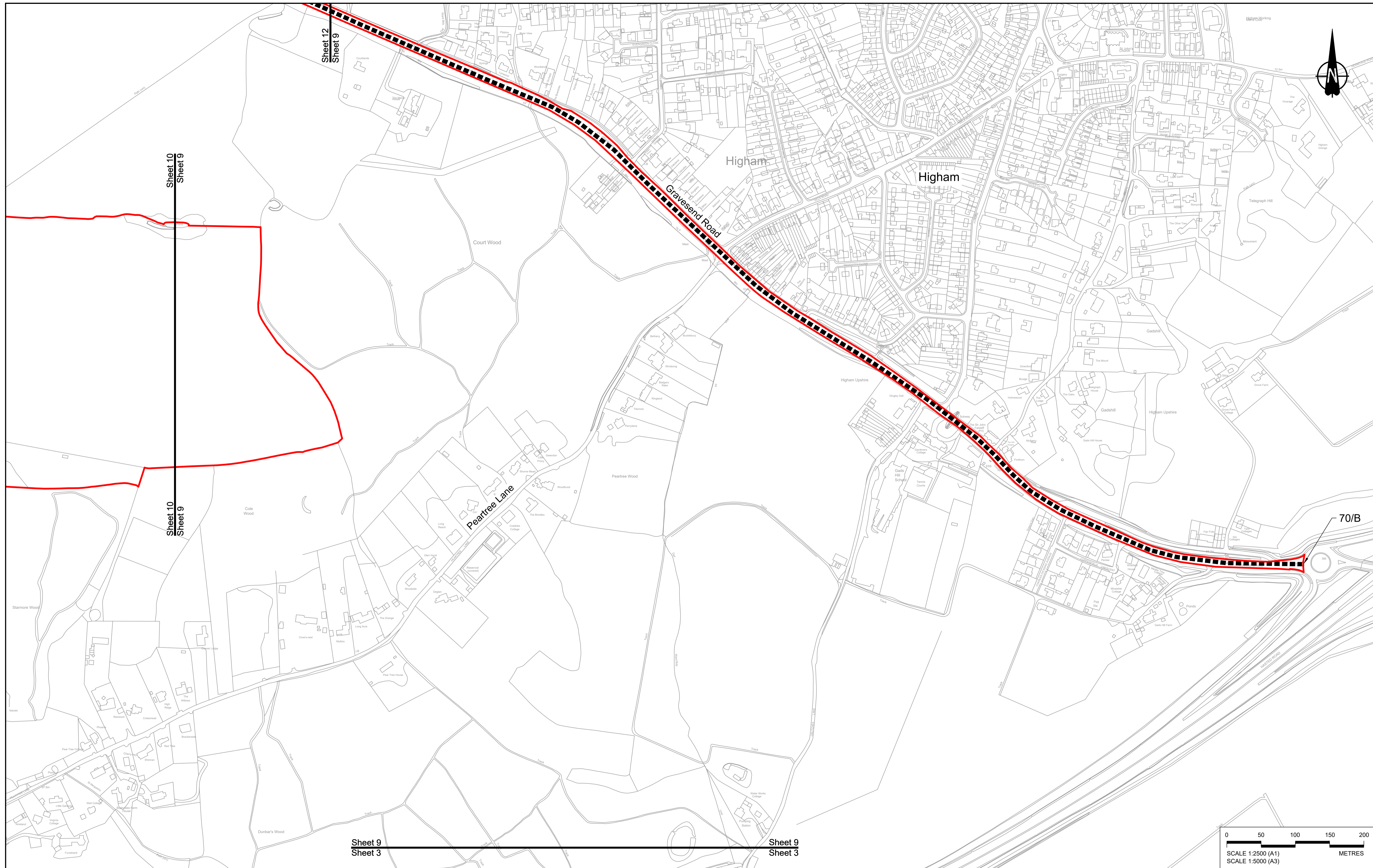

Contains Ordnance Survey data. © Crown copyright and database rights 2022. Ordnance Survey 100030649

P01	SB	19/10/2022	DCO Application	GP	BB	ASB
Rev	Status	Rev. Date	Purpose of revision	Drawn	Check'd	Apprv'd

NOTES:

- The proposed temporary restrictions of use shown here will be subject to change as part of detailed design development. Any changes will be limited to being within the constraints included in the Development Consent Order (application document reference TR010032/APP/3.1).
- These plans should be read in conjunction with Schedule 3 of the Development Consent Order (application document reference TR010032/APP/3.1).

LEGEND:

- Order Limits
- — — Local Authority Boundary
- ▬▬▬▬ Streets subject to temporary alteration, diversion and restriction of use

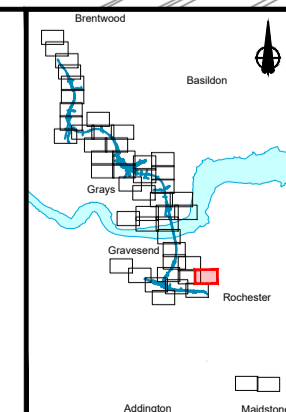

Client: **national highways**

Project: **LOWER THAMES CROSSING**

Status	DCO Application	Original Size	Revision
Application Document Number	TR010032/APP/2.8	A1	P01
Drawing Title	STREETS SUBJECT TO TEMPORARY RESTRICTIONS OF USE, REGULATION 5(2)(k) & 5(2)(o), SHEET 9		
Drawing Number	HE540039-CJV-BOP-SZZ_GN000000_-DR-CX-40007		

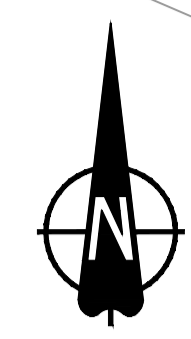
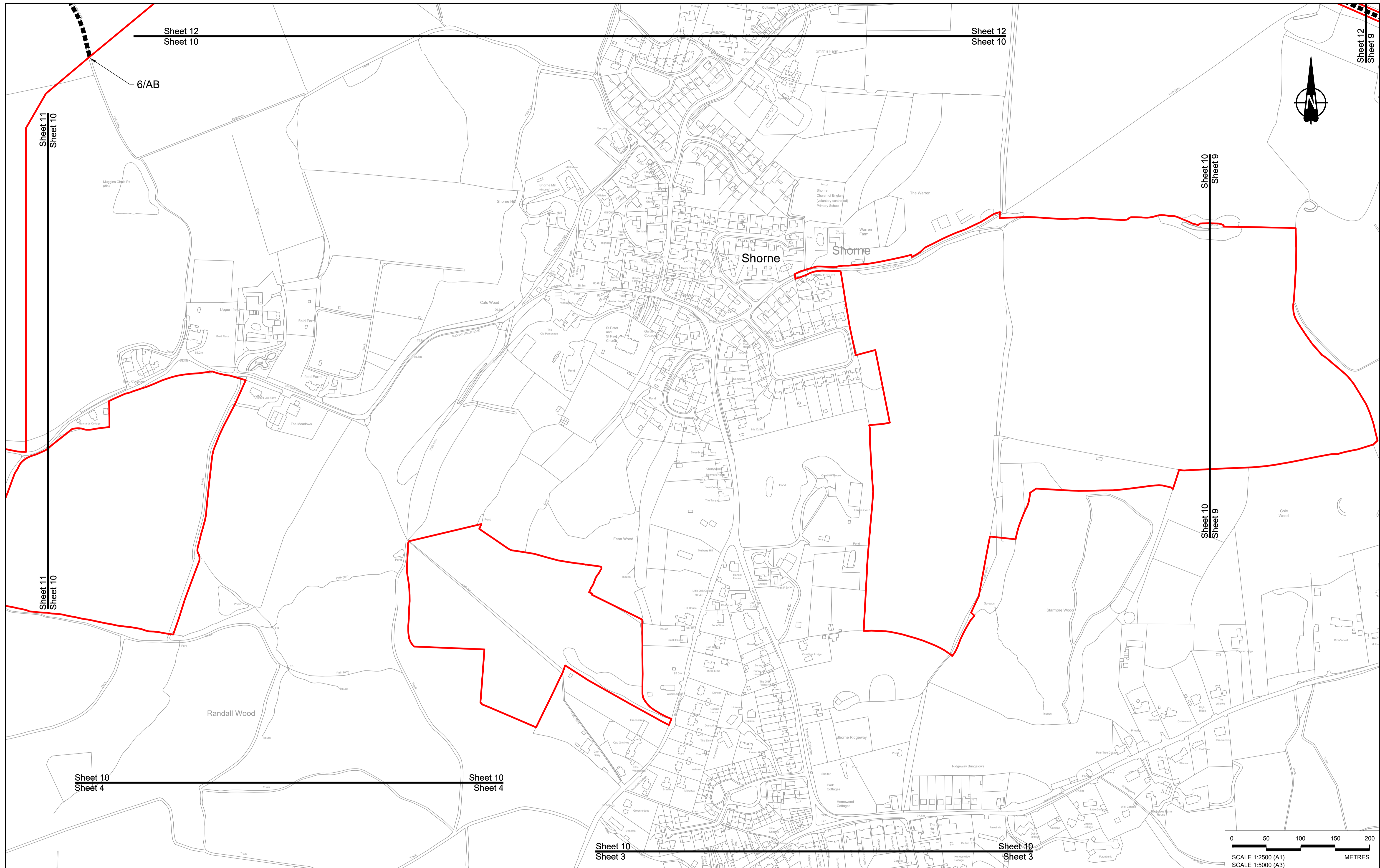

Contains Ordnance Survey data. © Crown copyright and database rights 2022. Ordnance Survey 100035649						
P01	SB	19/10/2022	DCO Application	GP	BB	ASB
Rev	Status	Rev. Date	Purpose of revision	Drawn	Check'd	Appr'd

NOTES:

- The proposed temporary restrictions of use shown here will be subject to change as part of detailed design development. Any changes will be limited to being within the constraints included in the Development Consent Order (application document reference TR010032/APP/3.1).
- These plans should be read in conjunction with Schedule 3 of the Development Consent Order (application document reference TR010032/APP/3.1).

LEGEND:

- Order Limits
- Local Authority Boundary
- ▣ Streets subject to temporary alteration, diversion and restriction of use

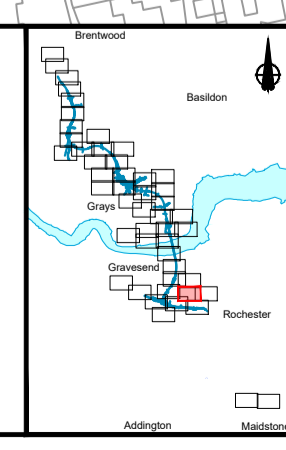

national highways

Project
LOWER THAMES CROSSING

Status	DCO Application	Original Size	A1	Revision	P01
Application Document Number	TR010032/APP/2.8	Scale	1:2500		
Drawing title	STREETS SUBJECT TO TEMPORARY RESTRICTIONS OF USE, REGULATION 5(2)(k) & 5(2)(o), SHEET 10				
Drawing Number	HE540039-CJV-BOP-SZZ_GN000000_-DR-CX-40008				

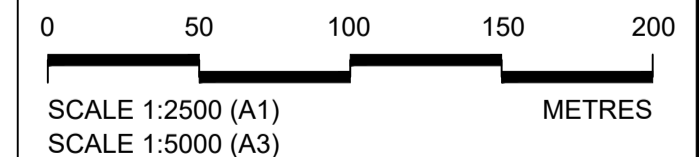
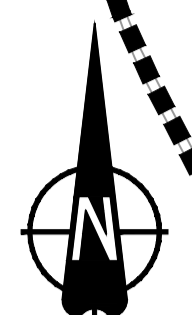
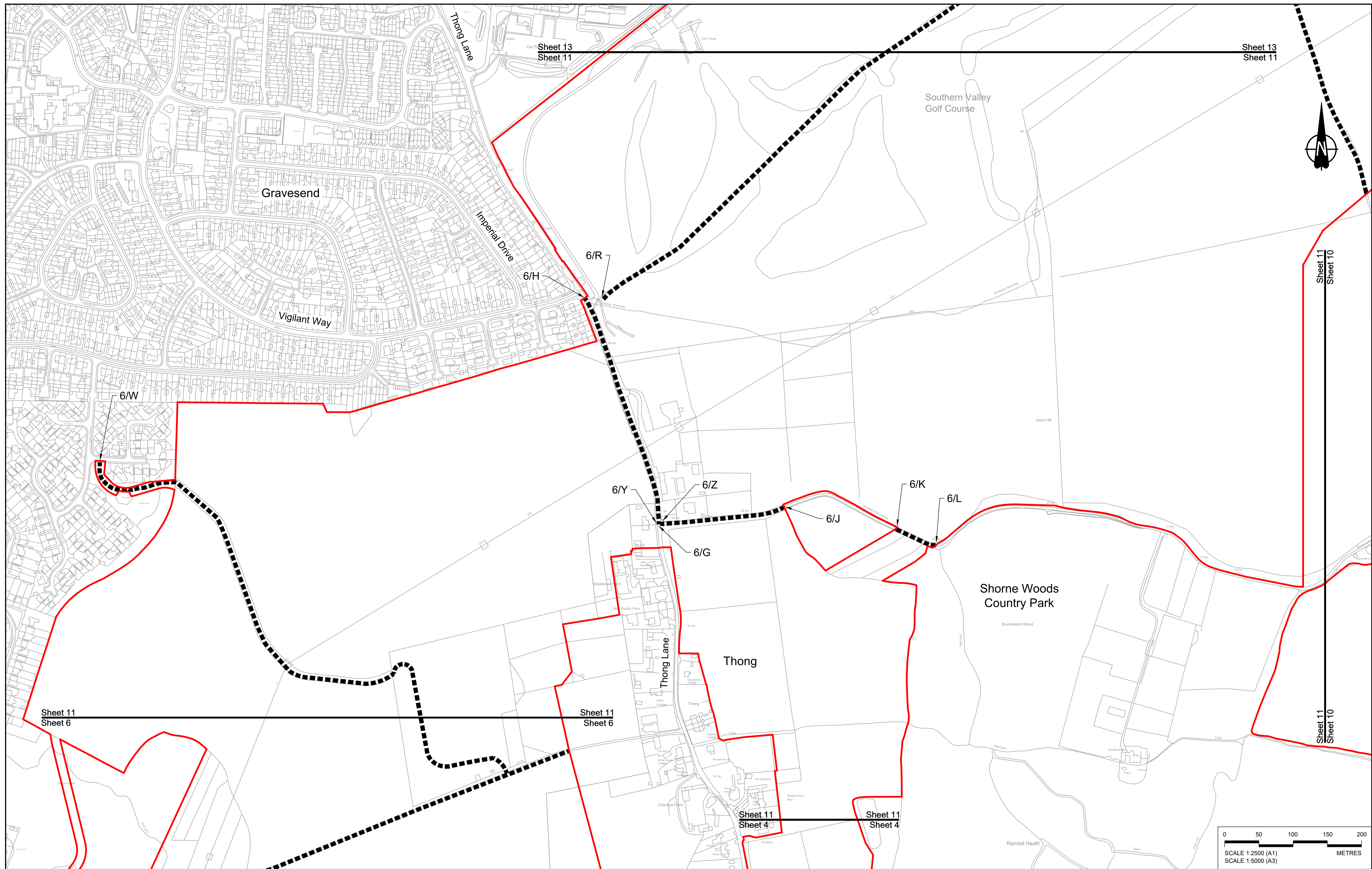

Contains Ordnance Survey data. © Crown copyright and database rights 2022. Ordnance Survey 100039649

Rev	Status	Rev. Date	Purpose of revision	Drawn	Chck'd	Apprv'd
P01	SB	19/10/2022	DCO Application	GP	BB	ASB

NOTES:

- The proposed temporary restrictions of use shown here will be subject to change as part of detailed design development. Any changes will be limited to being within the constraints included in the Development Consent Order (application document reference TR010032/APP/3.1).
- These plans should be read in conjunction with Schedule 3 of the Development Consent Order (application document reference TR010032/APP/3.1).

LEGEND:

- Order Limits
- Local Authority Boundary
- ▣ Streets subject to temporary alteration, diversion and restriction of use

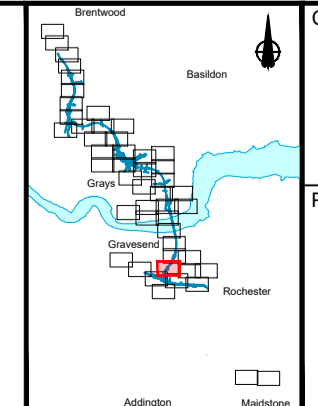

Client: **national highways**

Project: **LOWER THAMES CROSSING**

Status	DCO Application	Original Size	A1	Revision	P01
Application Document Number	TR010032/APP/2.8	Scale	1:2500		
Drawing title	STREETS SUBJECT TO TEMPORARY RESTRICTIONS OF USE, REGULATION 5(2)(k) & 5(2)(o), SHEET 11				
Drawing Number	HE540039-CJV-BOP-SZZ_GN000000_-DR-CX-40009				

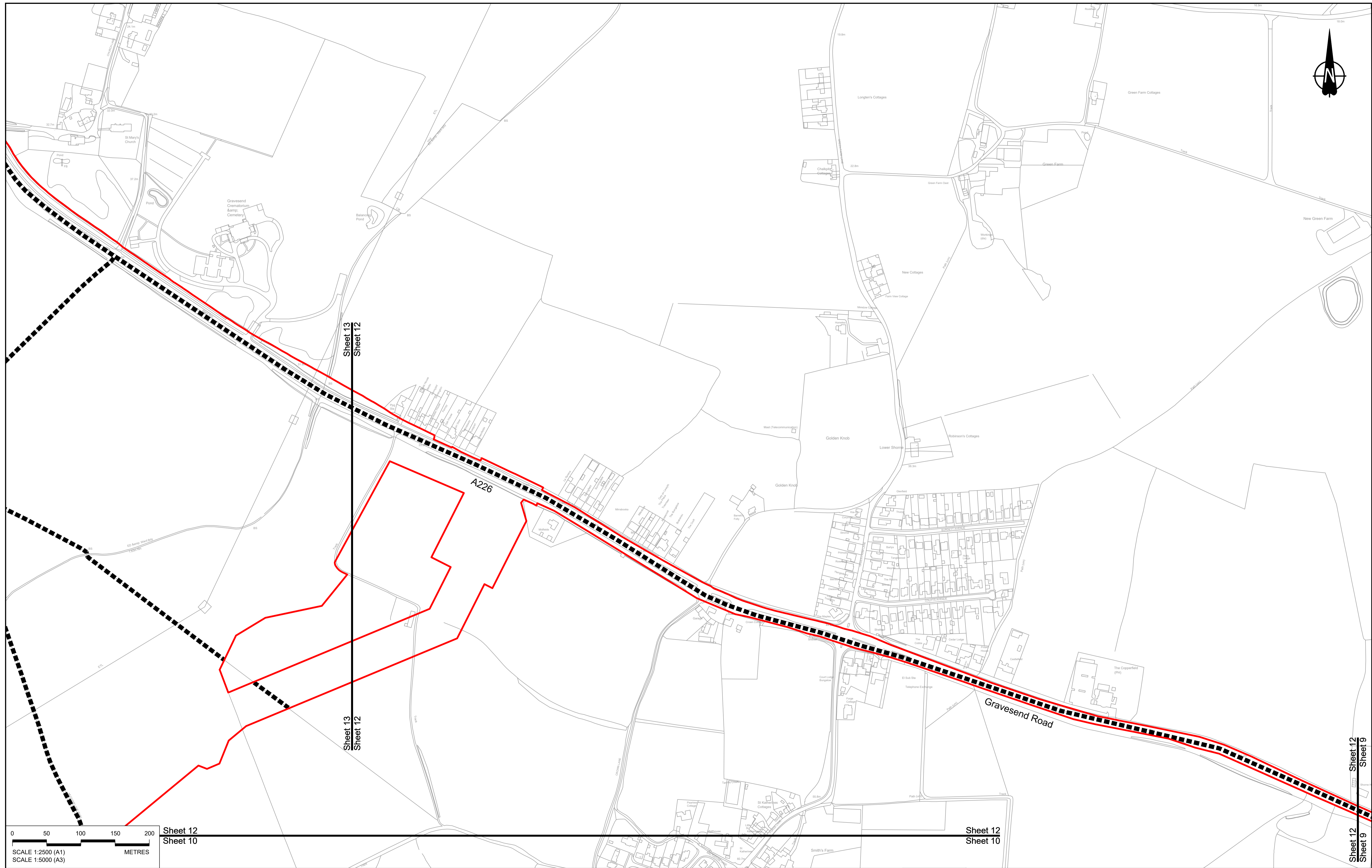

Sheet 12
Sheet 10

Sheet 12
Sheet 10

Sheet 12
Sheet 9

Contains Ordnance Survey data. © Crown copyright and database rights 2022. Ordnance Survey 100039649					
P01	SB	19/10/2022	DCO Application	GP	BB ASB
Rev	Status	Rev. Date	Purpose of revision	Drawn	Check'd
				Apprv'd	

NOTES:

- The proposed temporary restrictions of use shown here will be subject to change as part of detailed design development. Any changes will be limited to being within the constraints included in the Development Consent Order (application document reference TR010032/APP/3.1).
- These plans should be read in conjunction with Schedule 3 of the Development Consent Order (application document reference TR010032/APP/3.1).

LEGEND:

- Order Limits
- Local Authority Boundary
- ▬▬▬ Streets subject to temporary alteration, diversion and restriction of use

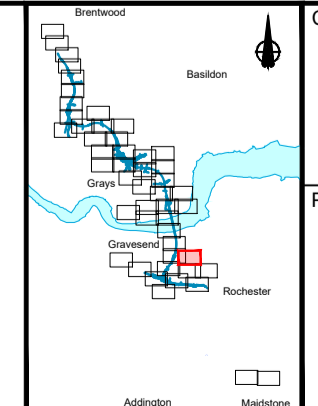

Client

Project

LOWER THAMES CROSSING

Status	DCO Application	Original Size	A1	Revision	P01
Application Document Number	TR010032/APP/2.8	Scale	1:2500		
Drawing title	STREETS SUBJECT TO TEMPORARY RESTRICTIONS OF USE, REGULATION 5(2)(k) & 5(2)(o), SHEET 12				
Drawing Number	HE540039-CJV-BOP-SZZ_GN000000_-DR-CX-40050				

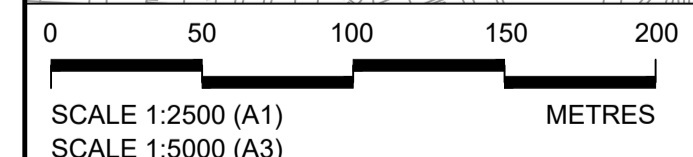
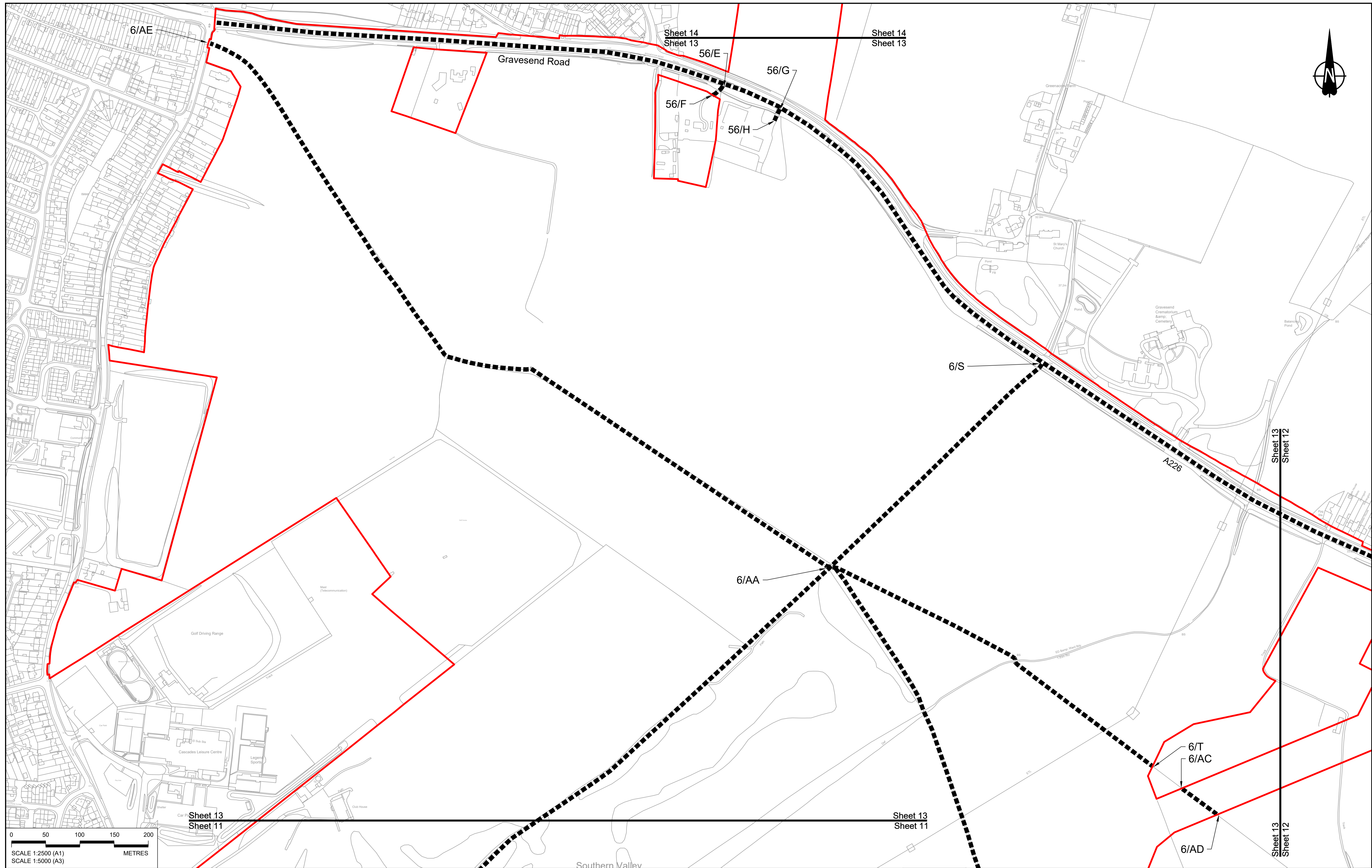

Contains Ordnance Survey data. © Crown copyright and database rights 2022. Ordnance Survey 100039649

Rev	Status	Rev. Date	Purpose of revision	Drawn	Check'd	Appr'd
P01	S8	19/10/2022	DCO Application	GP	BB	ASB
P02	S8	19/07/2023	Deadline 1	GP	RO	ASB

NOTES:

- The proposed temporary restrictions of use shown here will be subject to change as part of detailed design development. Any changes will be limited to being within the constraints included in the Development Consent Order (application document reference TR010032/APP/3.1).
- These plans should be read in conjunction with Schedule 3 of the Development Consent Order (application document reference TR010032/APP/3.1).

LEGEND:

- Order Limits
- Local Authority Boundary
- Streets subject to temporary alteration, diversion and restriction of use

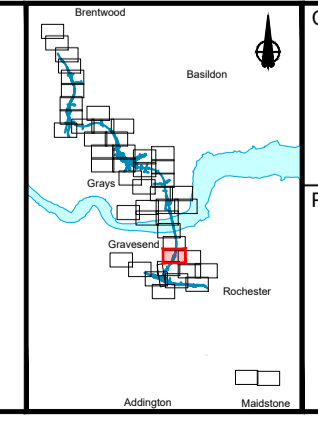

Client: **national highways**

Project: **LOWER THAMES CROSSING**

Status	DCO Application	Original Size	A1	Revision	P02
Application Document Number	TR010032/APP/2.8	Scale	1:2500		
Drawing title	STREETS SUBJECT TO TEMPORARY RESTRICTIONS OF USE, REGULATION 5(2)(k) & 5(2)(o), SHEET 13				
Drawing Number	HE540039-CJV-BOP-SZZ_GN000000_-DR-CX-40010				

Sheet 15
Sheet 14

Sheet 15
Sheet 14

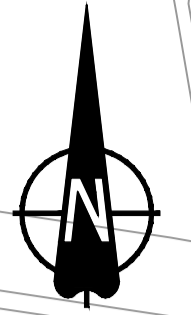

Thames Estuary
and Marshes,
SPA, SSSI and
Ramsar site

Filborough Marshes

Lower Higham Road

Church Lane

70/A

Sheet 14
Sheet 13

Sheet 14
Sheet 13

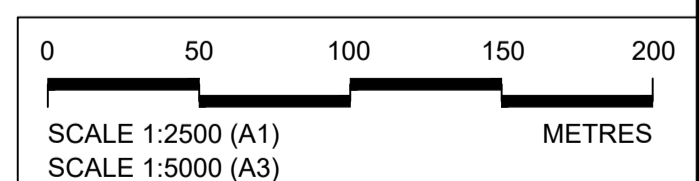

Contains Ordnance Survey data. © Crown copyright and database rights 2022. Ordnance Survey 100030649

Rev	Status	Rev. Date	Purpose of revision	Drawn	Chk'd	Apprv'd
P01	SB	19/10/2022	DCO Application	GP	BB	ASB

NOTES:

- The proposed temporary restrictions of use shown here will be subject to change as part of detailed design development. Any changes will be limited to being within the constraints included in the Development Consent Order (application document reference TR010032/APP/3.1).
- These plans should be read in conjunction with Schedule 3 of the Development Consent Order (application document reference TR010032/APP/3.1).

LEGEND:

- Order Limits
- Local Authority Boundary
- Streets subject to temporary alteration, diversion and restriction of use

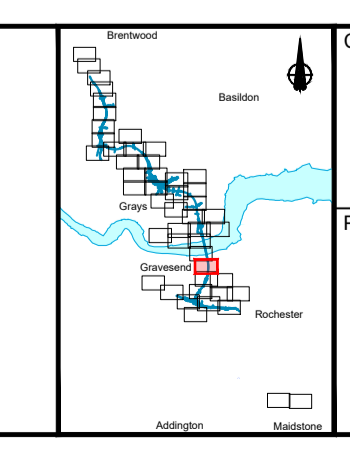

Client: **national highways**

Project: **LOWER THAMES CROSSING**

Status	DCO Application	Original Size	A1	Revision	P01
Application Document Number	TR010032/APP/2.8	Scale	1:2500		
Drawing Title	STREETS SUBJECT TO TEMPORARY RESTRICTIONS OF USE, REGULATION 5(2)(k) & 5(2)(o), SHEET 14				
Drawing Number	HE540039-CJV-BOP-SZZ_GN000000_-DR-CX-40011				

Sheet 16
Sheet 15

Sheet 16
Sheet 15



Thurrock Council
Gravesham Borough Council

River Thames

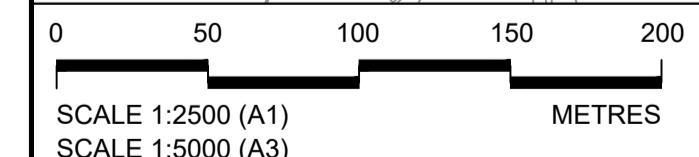
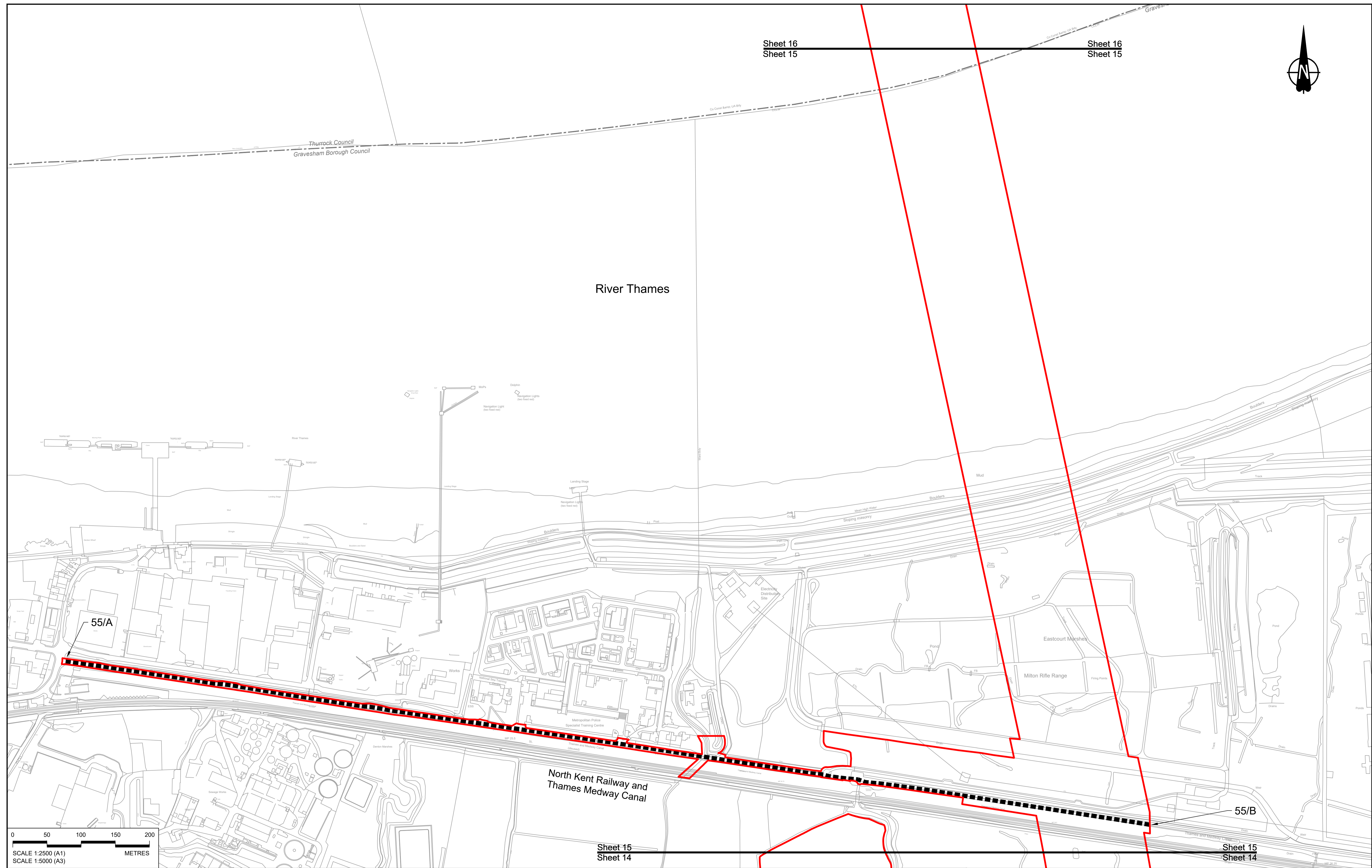

Sheet 15
Sheet 14

Sheet 15
Sheet 14

Contains Ordnance Survey data. © Crown copyright and database rights 2022. Ordnance Survey 100030649

Rev	Status	Rev. Date	Purpose of revision	Drawn	Chkd	Apprv'd
P01	SB	19/10/2022	DCO Application	GP	BB	ASB

NOTES:

- The proposed temporary restrictions of use shown here will be subject to change as part of detailed design development. Any changes will be limited to being within the constraints included in the Development Consent Order (application document reference TR010032/APP/3.1).
- These plans should be read in conjunction with Schedule 3 of the Development Consent Order (application document reference TR010032/APP/3.1).

LEGEND:

- Order Limits
- - - Local Authority Boundary
- ■ ■ ■ Streets subject to temporary alteration, diversion and restriction of use

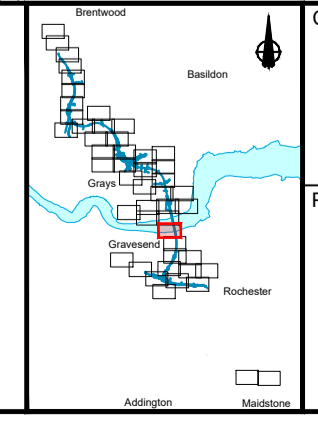

Client: **national highways**

Project: **LOWER THAMES CROSSING**

Status	DCO Application	Original Size	A1	Revision	P01
Application Document Number	TR010032/APP/2.8	Scale	1:2500		
Drawing title	STREETS SUBJECT TO TEMPORARY RESTRICTIONS OF USE, REGULATION 5(2)(k) & 5(2)(o), SHEET 15				
Drawing Number	HE540039-CJV-BOP-SZZ_GN000000_-DR-CX-40012				

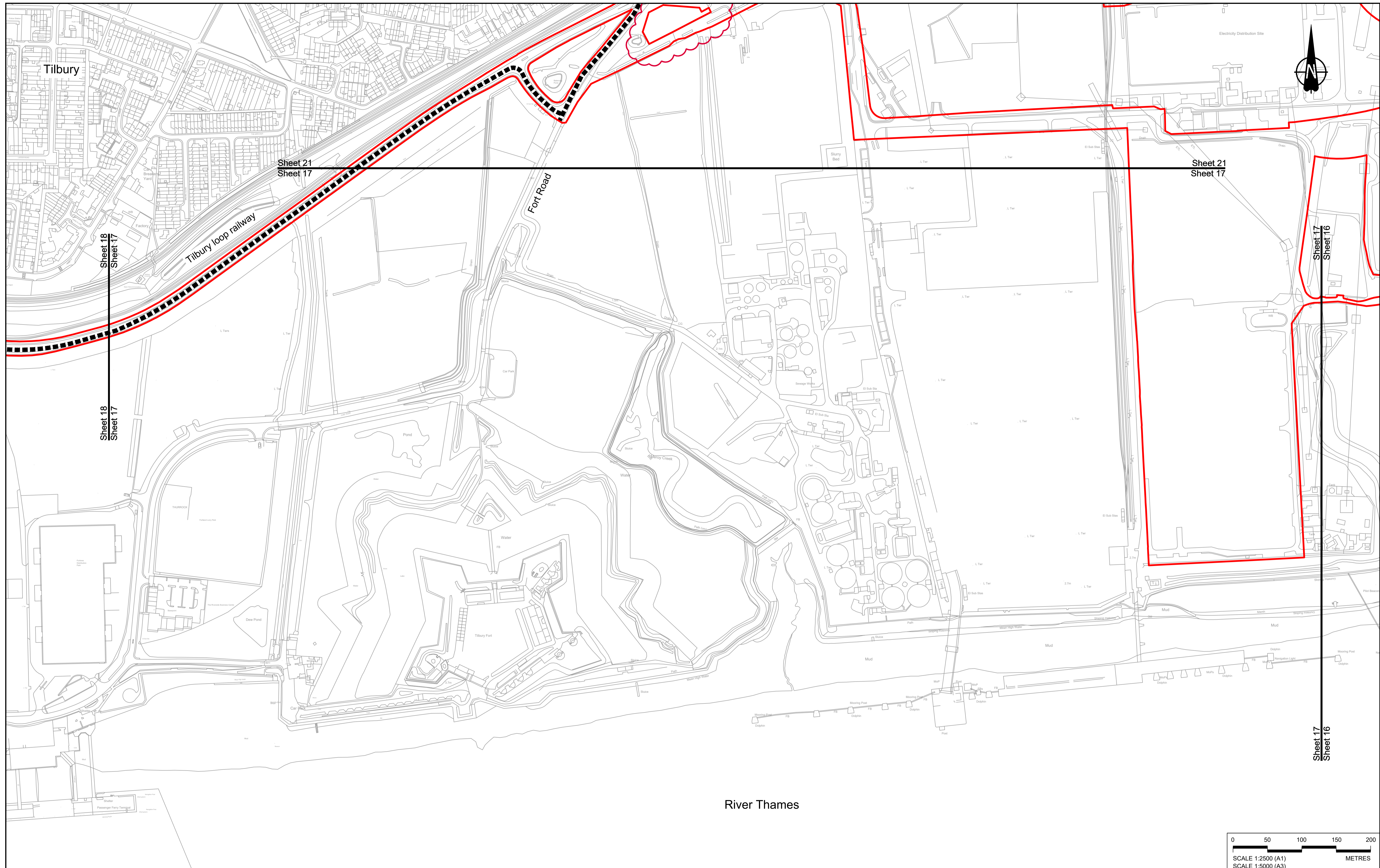

Sheet 18
Sheet 17

Sheet 21
Sheet 17

Sheet 21
Sheet 17

Sheet 17
Sheet 16

River Thames

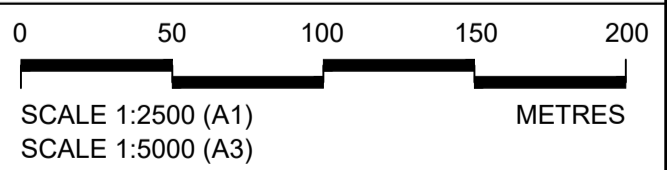

Contains Ordnance Survey data. © Crown copyright and database rights 2022. Ordnance Survey 100030649

P01	S8	19/10/2022	DCO Application	GP	BB	ASB
P02	S8	17/11/2023	Deadline 7	GP	RO	ASB
Rev	Status	Rev. Date	Purpose of revision	Drawn	Chkd	Apprv'd

NOTES:

- The proposed temporary restrictions of use shown here will be subject to change as part of detailed design development. Any changes will be limited to being within the constraints included in the Development Consent Order (application document reference TR010032/APP/3.1).
- These plans should be read in conjunction with Schedule 3 of the Development Consent Order (application document reference TR010032/APP/3.1).

LEGEND:

- Order Limits
- Local Authority Boundary
- Streets subject to temporary alteration, diversion and restriction of use

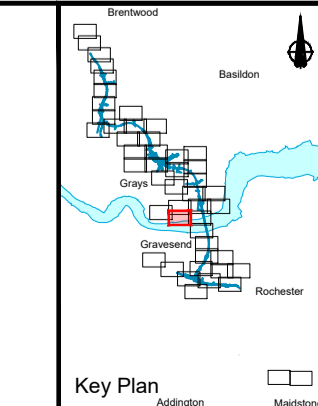

Client: **national highways**

Project: **LOWER THAMES CROSSING**

Status	DCO Application	Original Size	A1	Revision	P02
Application Document Number	TR010032/APP/2.8	Scale	1:2500		
Drawing title	STREETS SUBJECT TO TEMPORARY RESTRICTIONS OF USE, REGULATION 5(2)(k) & 5(2)(o), SHEET 17				
Drawing Number	HE540039-CJV-BOP-SZZ_GN000000_-DR-CX-40014				

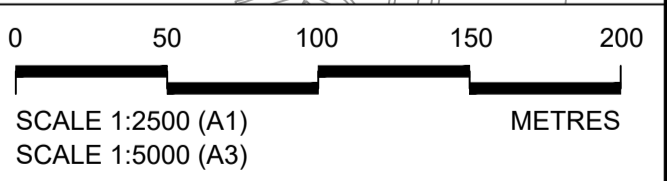

Contains Ordnance Survey data. © Crown copyright and database rights 2022. Ordnance Survey 100039649

P01	SB	19/10/2022	DCO Application	GP	BB	ASB
Rev	Status	Rev. Date	Purpose of revision	Drawn	Check'd	Apprv'd

NOTES:

1. The proposed temporary restrictions of use shown here will be subject to change as part of detailed design development. Any changes will be limited to being within the constraints included in the Development Consent Order (application document reference TR010032/APP/3.1).
2. These plans should be read in conjunction with Schedule 3 of the Development Consent Order (application document reference TR010032/APP/3.1).

LEGEND:

	Order Limits
	Local Authority Boundary
	Streets subject to temporary alteration, diversion and restriction of use

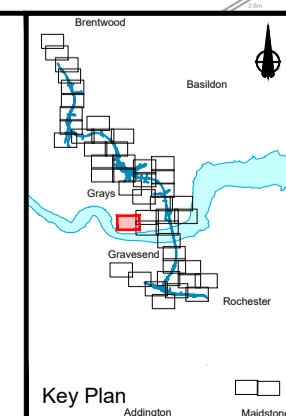

Client:

Project: **LOWER THAMES CROSSING**

Status	DCO Application	Original Size	A1	Revision	P01
Application Document Number	TR010032/APP/2.8	Scale	1:2500		
Drawing title	STREETS SUBJECT TO TEMPORARY RESTRICTIONS OF USE, REGULATION 5(2)(k) & 5(2)(o), SHEET 18				
Drawing Number	HE540039-CJV-BOP-SZZ_GN000000_-DR-CX-40015				

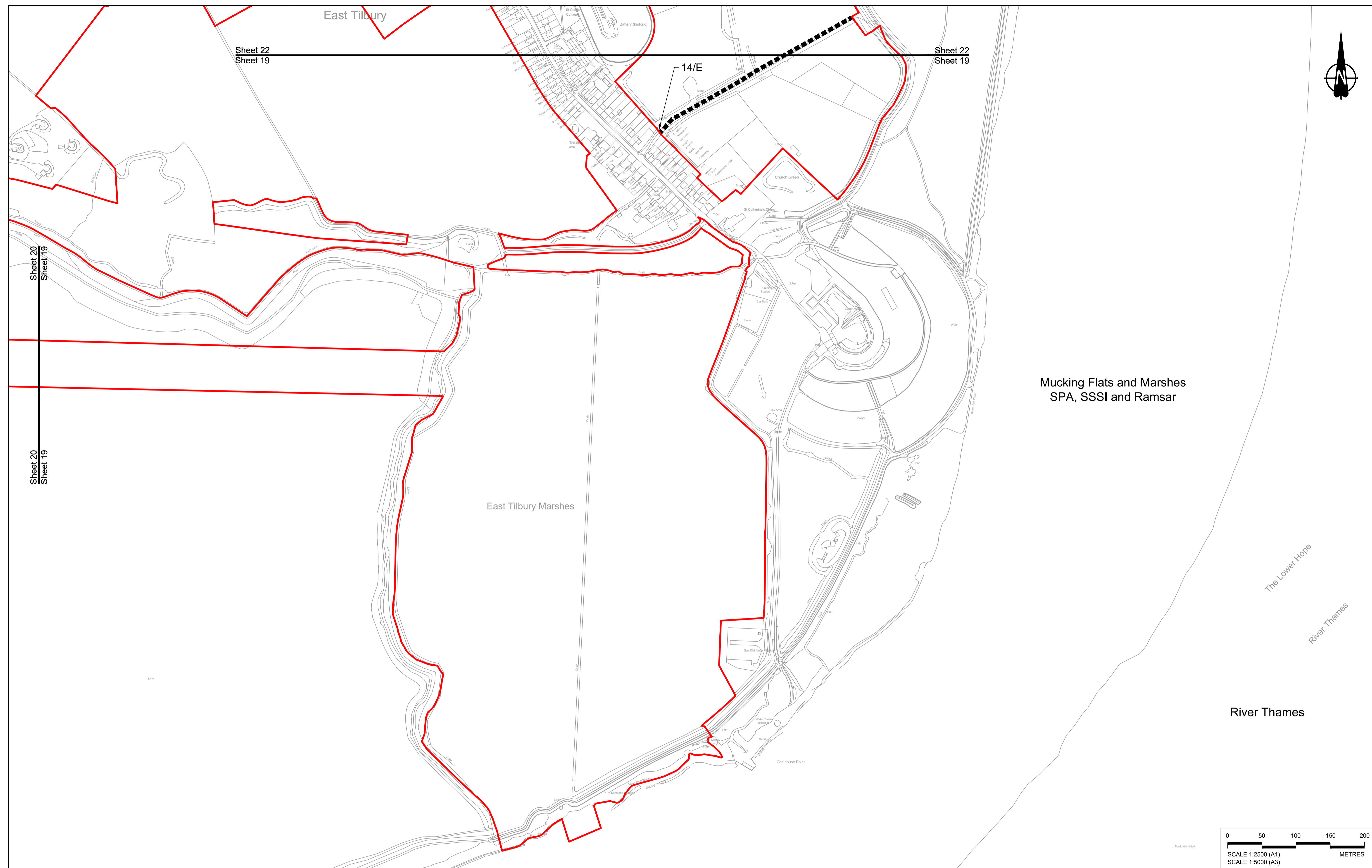

Contains Ordnance Survey data. © Crown copyright and database rights 2022. Ordnance Survey 100035649

P01	SB	19/10/2022	DCO Application	GP	BB	ASB
Rev	Status	Rev. Date	Purpose of revision	Drawn	Chck'd	Apprv'd

NOTES:

- The proposed temporary restrictions of use shown here will be subject to change as part of detailed design development. Any changes will be limited to being within the constraints included in the Development Consent Order (application document reference TR010032/APP/3.1).
- These plans should be read in conjunction with Schedule 3 of the Development Consent Order (application document reference TR010032/APP/3.1).

LEGEND:

- Order Limits
- — — Local Authority Boundary
- ■ ■ ■ Streets subject to temporary alteration, diversion and restriction of use

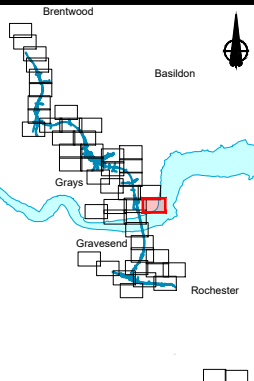

Client



Project

LOWER THAMES CROSSING

Status	DCO Application	Original Size	A1	Revision	P01
Application Document Number	TR010032/APP/2.8	Scale	1:2500		
Drawing Title	STREETS SUBJECT TO TEMPORARY RESTRICTIONS OF USE, REGULATION 5(2)(k) & 5(2)(o), SHEET 19				
Drawing Number	HE540039-CJV-BOP-SZZ_GN000000_DR-CX-40016				

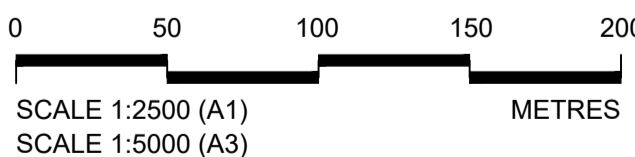
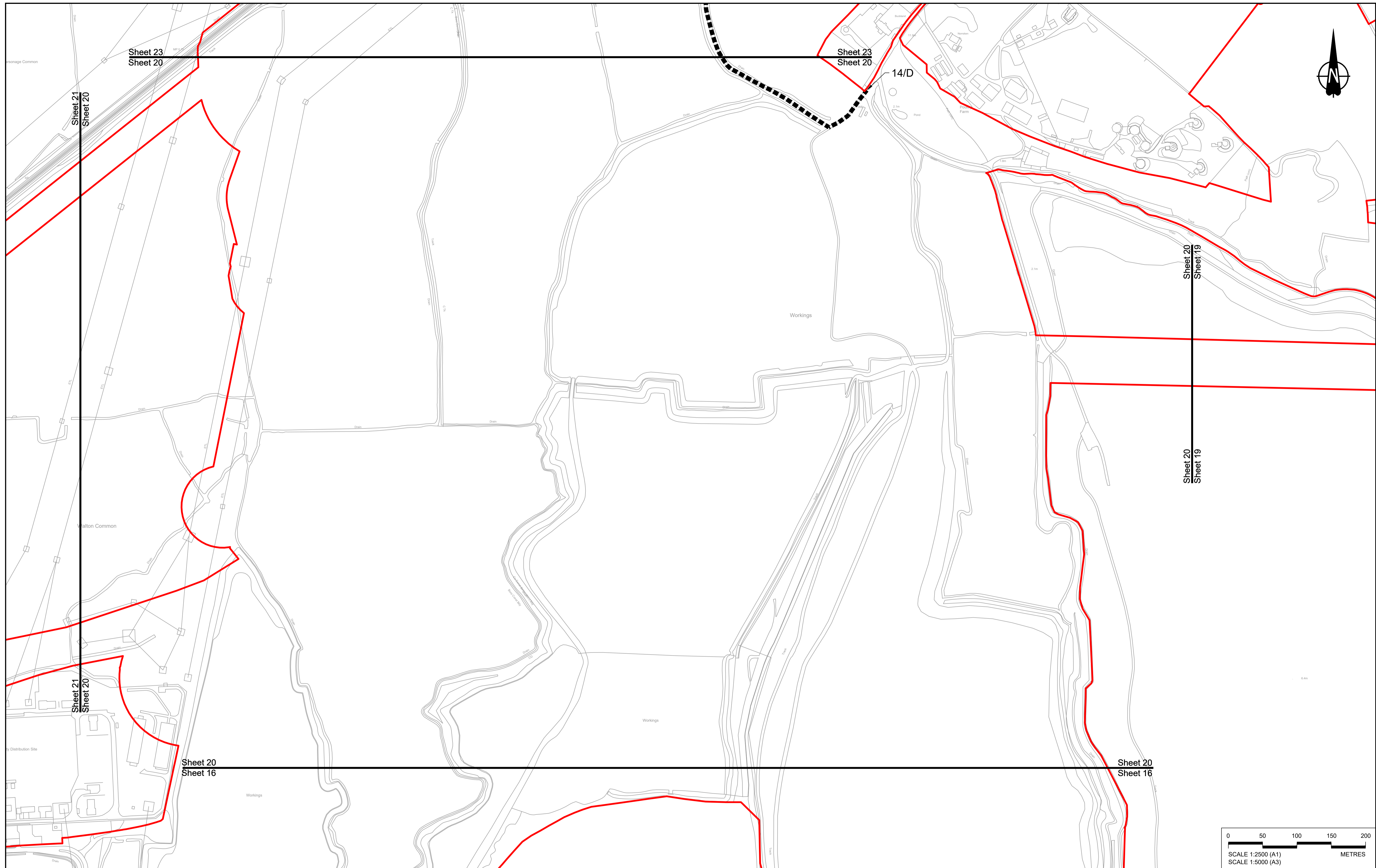

Contains Ordnance Survey data. © Crown copyright and database rights 2022. Ordnance Survey 100035649

P01	SB	19/10/2022	DCO Application	GP	BB	ASB
Rev	Status	Rev. Date	Purpose of revision	Drawn	Chck'd	Apprv'd

NOTES:

- The proposed temporary restrictions of use shown here will be subject to change as part of detailed design development. Any changes will be limited to being within the constraints included in the Development Consent Order (application document reference TR010032/APP/3.1).
- These plans should be read in conjunction with Schedule 3 of the Development Consent Order (application document reference TR010032/APP/3.1).

LEGEND:

- Order Limits
- — — Local Authority Boundary
- ■ ■ ■ Streets subject to temporary alteration, diversion and restriction of use

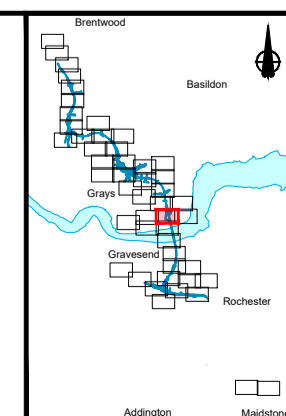

Client

Project

LOWER THAMES CROSSING

Status	DCO Application	Original Size	Revision
Application Document Number	TR010032/APP/2.8	A1	P01
Drawing title	STREETS SUBJECT TO TEMPORARY RESTRICTIONS OF USE, REGULATION 5(2)(k) & 5(2)(o), SHEET 20		
Drawing Number	HE540039-CJV-BOP-SZZ_GN000000_-DR-CX-40017		

If you need help accessing this or any other National Highways information, please call **0300 123 5000** and we will help you.

© Crown copyright 2023.

You may re-use this information (not including logos) free of charge in any format or medium, under the terms of the Open Government Licence. To view this licence:

visit www.nationalarchives.gov.uk/doc/open-government-licence/

write to the **Information Policy Team, The National Archives, Kew, London TW9 4DU**, or email psi@nationalarchives.gsi.gov.uk.

Mapping (where present): © Crown copyright and database rights 2023 OS 100030649. You are permitted to use this data solely to enable you to respond to, or interact with, the organisation that provided you with the data. You are not permitted to copy, sub-licence, distribute or sell any of this data to third parties in any form.

If you have any enquiries about this publication email info@nationalhighways.co.uk or call **0300 123 5000***.

*Calls to 03 numbers cost no more than a national rate call to an 01 or 02 number and must count towards any inclusive minutes in the same way as 01 and 02 calls.

These rules apply to calls from any type of line including mobile, BT, other fixed line or payphone. Calls may be recorded or monitored.

Printed on paper from well-managed forests and other controlled sources when issued directly by National Highways.

Registered office Bridge House, 1 Walnut Tree Close, Guildford GU1 4LZ

National Highways Limited registered in England and Wales number 09346363